

RECD MAY 6 1947

0923

### Petition for Zoning Re-Classification

To The Zoning Commissioner of Baltimore County...

Gustav B. Biedermann, et al. legal owners of the property situated on southwest side of Henry Ave., near Overlea, in the 14th District of Balto. Co., beginning 42.6' northwest of Marion Ave., thence northwest, on said side of Henry Avenue, 150' with a rectangular depth southwest of 145'.

herely petition that the zoning status of the above described property be re-classified, pursuant to the Zoning Law of Baltimore County, from an "R-1" Residence zone to an "R-2" Residence zone.

Reasons for Re-Classification:

Character of use for which above property is to be used: semi-detached houses

To be approved by Buildings Dept.

Size and height of building: front... feet; depth... feet; height... feet.

To be approved by Zoning Dept.

Front and side set backs of building from street lines: front... feet; side... feet.

Property to be posted as prescribed by Zoning Regulations.

we, agree to pay expenses of above re-classification, advertising, posting, etc., upon filing of this petition, and further agree to and are to be bound by the zoning regulations and restrictions of Baltimore County adopted pursuant to the Zoning Law for Baltimore County.

Gustav B. Biedermann  
Catherine M. Biedermann  
Legal Owner

Address 7533 Belair Road

ORDERED By The Zoning Commissioner of Baltimore County, this 6th day of May, 1947, that the subject matter of this petition be advertised, as required by the "Zoning Law of Baltimore County, in a newspaper of general circulation throughout Baltimore County, that property be posted, and that the public hearing hereon be had in the office of the Zoning Commissioner of Baltimore County, in the Record Bldg., in Towson, Baltimore County, on the 26th day of May, 1947, at 5:00 o'clock P.M.

Charles H. Deane  
Zoning Commissioner of Baltimore County

(over)

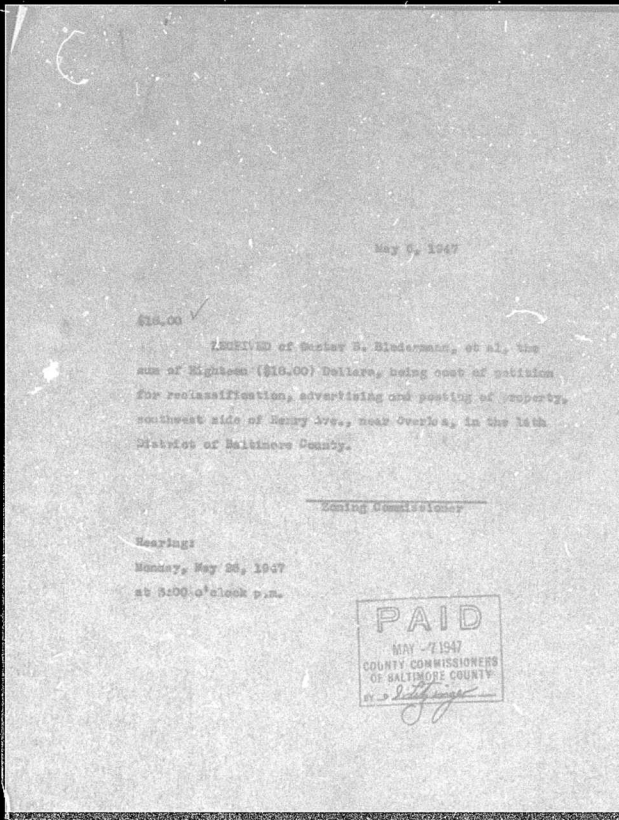

### CERTIFICATE OF POSTING

ZONING DEPARTMENT OF BALTIMORE COUNTY  
Towson, Maryland

923

District: 14 Date of Posting: May 8/47  
Posted for: Gustav B. Biedermann  
Petitioner: Gustav B. Biedermann  
Location of property: Southwest side of Henry Ave  
42.6 feet northwest of Marion Ave  
Location of signs: Southwest side of Henry Ave  
42.6 feet northwest of Marion Ave  
Remarks: \_\_\_\_\_  
Posted by: Henry B. Smith Signature Date of return: May 9/47

RECD MAY 17 1947

4925

### CERTIFICATE OF PUBLICATION

TOWSON, MD. May 16/47

"THIS IS TO CERTIFY", That the annexed advertisement was published in THE JEFFERSONIAN, a weekly newspaper printed and published in Towson, Baltimore County, Md., once in each of two successive weeks before the 5th day of May, 1947, the first publication appearing on the 7th day of May, 1947.

W. J. Jefferston  
THE JEFFERSONIAN,  
Manager.

Cost of Advertisement, \$ \_\_\_\_\_

NOTICE OF ZONING RECLASSIFICATION--14TH DIST. Pursuant to petition filed with the Zoning Commissioner of Baltimore County, Commission of reclassification from R-1 Residence Zone to R-2 Residence Zone of the property hereinafter described, the Zoning Commission of Baltimore County, by authority of the Zoning Act and Regulations, will hold a public hearing at 5:00 o'clock P.M., on the 26th day of May, 1947, at 5:00 o'clock P.M., at the office of the Zoning Commission, 1115 North Avenue, Towson, Maryland, to determine whether and described reclassification should be made and, if reclassified, semi-detached houses be erected thereon. All that parcel of land situated on the southwest side of Henry Avenue, in Baltimore County, beginning 42.6 feet northwest of Marion Avenue, thence northwest, on said side of Henry Avenue, 150 feet with a rectangular depth southwest of 145 feet, containing 15,000 square feet of land.

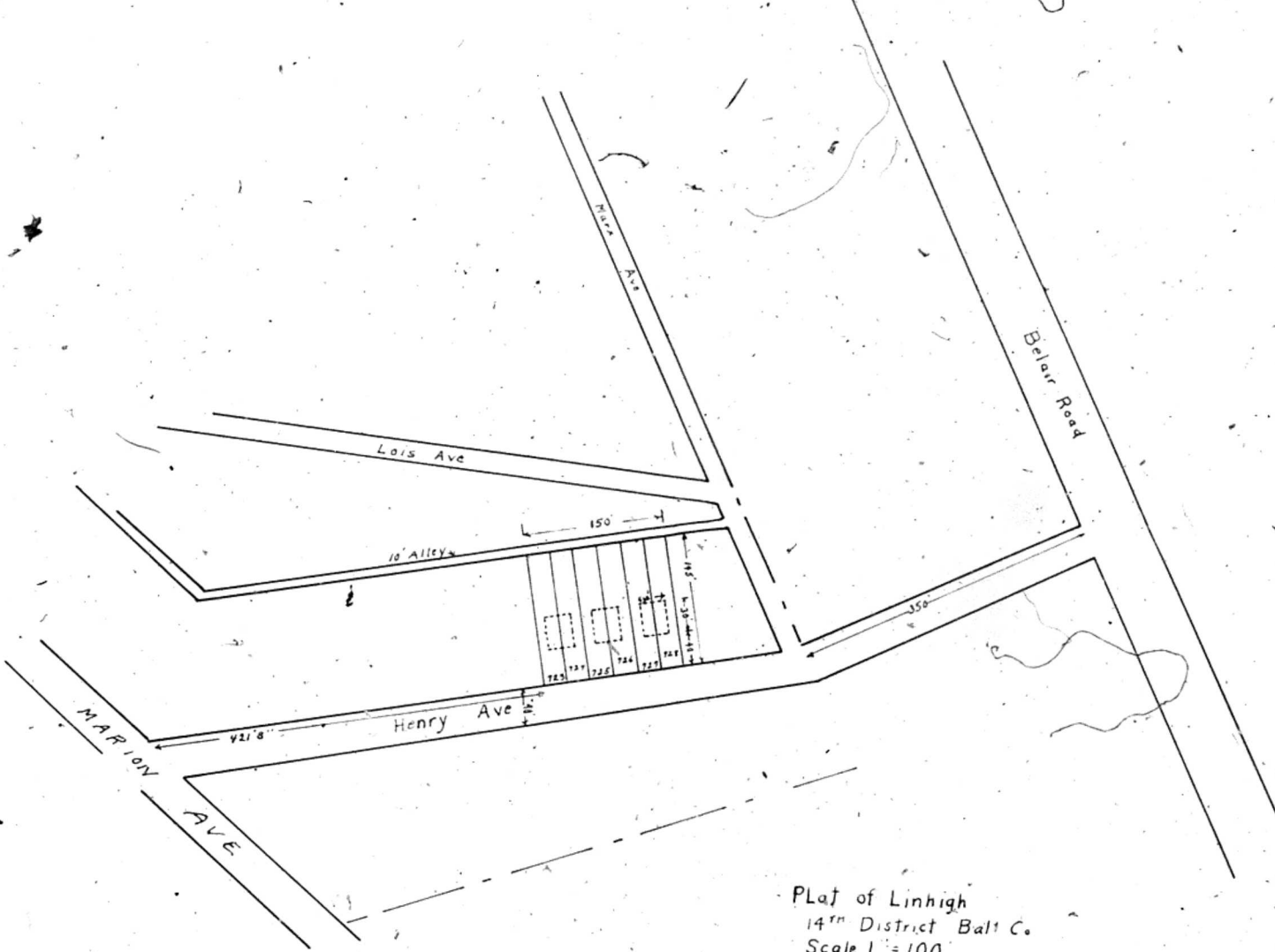

Plat of Linhigh  
 14<sup>th</sup> District Ball Co.  
 Scale 1" = 100'  
 Recorded 3/24/24 PLAT BOOK 7-81

