

999-R-5
MAP #11-C

#999-R-5
MAP #11-C

PETITION FOR (1) ZONING RECLASSIFICATION
(2) SPECIAL PERMIT

999-R-5
11th District
Philadelphia Road, 1000' x 300'

ORDERED by the Zoning Commissioner of Baltimore County this 14th day of August, 1947, that the subject matter of this petition be advertised in a newspaper of general circulation throughout Baltimore County and that the property be posted, as required by the Zoning Regulations and Act of Assembly aforesaid, and that a public hearing thereon be had in the office of the Zoning Commissioner of Baltimore County, Maryland, on the 2nd day of September, 1947, at 10:00 o'clock a.m.

Chas. H. Young
Building & Zoning Commissioner
of Baltimore County.

Upon hearing on petition (1) for reclassification of that parcel of land described therein from an "A" Residence Zone to an "C" Commercial Zone and (2) for Special Permit to use said property for Gasoline Service Station and it appearing by reason of location the said petitions should be granted, therefore:

It is this 5th day of September, 1947, ORDERED by the Zoning Commissioner of Baltimore County that the aforesaid two petitions be and the same are hereby granted; the (1) for reclassification as aforesaid and (2) for use of property for gasoline service station. This Order is based upon the condition that the setback of the southeast right-of-way line of Philadelphia Road and the service building to be erected shall not be nearer than 10 feet to the right-of-way line.

Chas. H. Young
Building & Zoning Commissioner
of Baltimore County.

Approved _____
County Commissioners of Baltimore County
Date 7.6.13, 1948 By CHAM
President

To the Zoning Commissioner of Baltimore County:
I, Rose Fensel Legal Owner

of that parcel of land situate on southeast side of Philadelphia Road, in the 11th District of Baltco. Co., beginning 1000' southeast of Red Line Road, thence northeast, on said side of Philadelphia Road, 200' with a rectangular lotth south-easterly of 300'.

certify petition (1) that the zoning status of the above described property be reclassified, pursuant to the Zoning Law of Baltimore County, from an "A" Residence Zone to an "C" Commercial Zone; and (2) for a Special Permit, under said Zoning Law and Zoning Regulations of Baltimore County, to use ~~the above~~ the above described property, (and improvements now or to be erected thereon), for Gasoline Service Station

Property to be posted as prescribed by Zoning Regulations.

I, or we, agree to pay expenses of the above reclassification and Special Permit, advertising, posting, etc., upon filing of this petition, and further agree to and are to be bound by the Zoning Regulations and Restrictions of Baltimore County, adopted pursuant to the Zoning Law for Baltimore County.

Rose Fensel
Local Owner
Baltimore, Md. U. S. D.

August 7, 1947

25.00 ✓

RECEIVED of Mrs. Rose Fensel the sum of Eighteen Dollars, being cost of petition for reclassification, advertising and posting of property southeast side of Philadelphia Road, 11th District of Baltimore County.

Chas. H. Young
Zoning Commissioner

Hearing:
Tuesday: September 2, 1947
at 10:00 A. M.

PAID
AUG 7 1947
COUNTY COMMISSIONERS
OF BALTIMORE COUNTY

FILED AUG 23 1947 #999

CERTIFICATE OF PUBLICATION

NOTICE OF ZONING RECLASSIFICATION AND SPECIAL PERMIT
The following is a copy of the advertisement as published in the JEFFERSONIAN, a weekly newspaper printed and published in Towson, Baltimore County, Md., on the 15th day of August, 1947.

TOWSON, MD. August 13, 1947
THIS IS TO CERTIFY, That the annexed advertisement was published in THE JEFFERSONIAN, a weekly newspaper printed and published in Towson, Baltimore County, Md., on the 15th day of August, 1947, before the 2nd day of September, 1947, the first publication appearing on the 15th day of August, 1947.

R. S. Cantley
THE JEFFERSONIAN,
Manager.

Cost of Advertisement, \$ _____

CERTIFICATE OF POSTING
ZONING DEPARTMENT OF BALTIMORE COUNTY
Towson, Maryland

999-5

District: "Commercial & Gas station"
Date of Posting: Aug 15/47
Posted for: Rose Fensel
Petitioner: Rose Fensel
Location of property: southeast side Phila Road 1090 feet southwest of Red Line Road
Location of Signs: southeast side Phila Road 1190 feet southwest of Red Line Road
Remarks:
Posted by: Henry G. Barbide Date of return: Aug 15/47

#999-RSV ✓

Red Lion Rd.

Scale 1/4" = 1' or 1/16" = 10'

Acreage Belonging to Applicant
Mrs Rose Pense

West from Red Lion Rd to
Zoning

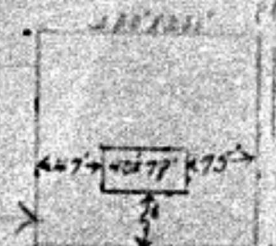

Old State Rd.
550'

750'