

PETITION FOR PERMIT FOR TEMPORARY USE

\$10.00
1683
#1683-T

IN THE MATTER OF :
Petition of : BEFORE THE
Glenn E. Martin Co., : ZONING COMMISSIONER OF
: BALTIMORE COUNTY

For Permit for
Temporary Use

To the Zoning Commissioner of Baltimore County:

GLENN E. MARTIN Co Legal Owner
and Convery Sign Company Lessee
Tenant

hereby petition for permit for temporary use as prescribed by the
Zoning Regulations of Baltimore County and the authority and procedure
conferred on said Zoning Commissioner, thereunder, to use

The following described parcel of land, to wit:

For 12x15 Adv. Sign directing to
store locations.

Southwest corner of Eastern Ave. & Wilson Point Road, 15th District
of Baltm. Co. fronting on Eastern Ave. 25 feet with a rectangular
depth southerly of 50 feet and binding on the west side of Wilson
Point Road.

And the (building) _____

For the temporary use as Adv 31GX

For the period of 2 YEARS

Subject to the following conditions: _____

Lessee Tenant _____

Address: _____

Glenn E. Martin Co.
John P. J.
Legal Owner John P. J.

Address G.E.M.C. Balt. 3. Md.

CONVERY SIGN CO.
J. CONVERY
518 PIERCE ST
K34701 Md.

ORDERED by the Zoning Commissioner of Baltimore County,
this 14th day of March, 1950 that the property
mentioned and described in this petition be posted, as required by
the aforesaid Zoning Regulations and Procedure, and that a public
hearing thereon be held in the office of the Zoning Commissioner of
Baltimore County, Maryland, on the 15th day of March, 1950
at 3:30 o'clock P.M.

Chas. A. Daring
Zoning Commissioner of
Baltimore County

Upon hearing on petition for temporary use permit
of the property described in the within petition for Adver-
tising Structure and it appearing that by reason of location,
the said petition should be granted, therefore:

It is this 14th day of May, 1950, ORDERED by the
Zoning Commissioner of Baltimore County, that the aforesaid
petition for temporary use permit be and the same is hereby
granted for the period of two (2) years, from the above date,
subject, however, to the setback from the right-of-way lines
of Eastern Avenue and Wilson Point Road as required by law.

Chas. A. Daring
Zoning Commissioner
of Baltimore County

March 16, 1950

\$10.00

RECEIVED of the Convery Sign Company the sum
of Ten (\$10.00) Dollars, being cost of petition for
Temporary use permit for erection of an Advertising
Sign at the southwest corner of Eastern Avenue and
Wilson Point Road, 15th District of Baltimore County.

Zoning Commissioner

Hearings:

Friday, March 31, 1950
at 3:30 p. m.

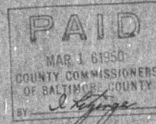

CERTIFICATE OF POSTING
ZONING DEPARTMENT OF BALTIMORE COUNTY
Towson, Maryland

1683-T

District 15 Date of Posting Mar 18/50

Posted for: Advertising Sign

Petitioner: Glenn E. Martin Co

Location of property: S.W. corner of Eastern Ave and

Wilson Point Road

Location of Signs: S.W. corner of Eastern Ave and

Wilson Point

Remarks: _____

Posted by: Harry C. Gortside Date of return: Mar 18/50

Signature _____

7

PENNSYLVANIA RAILROAD

EASTERN AVE

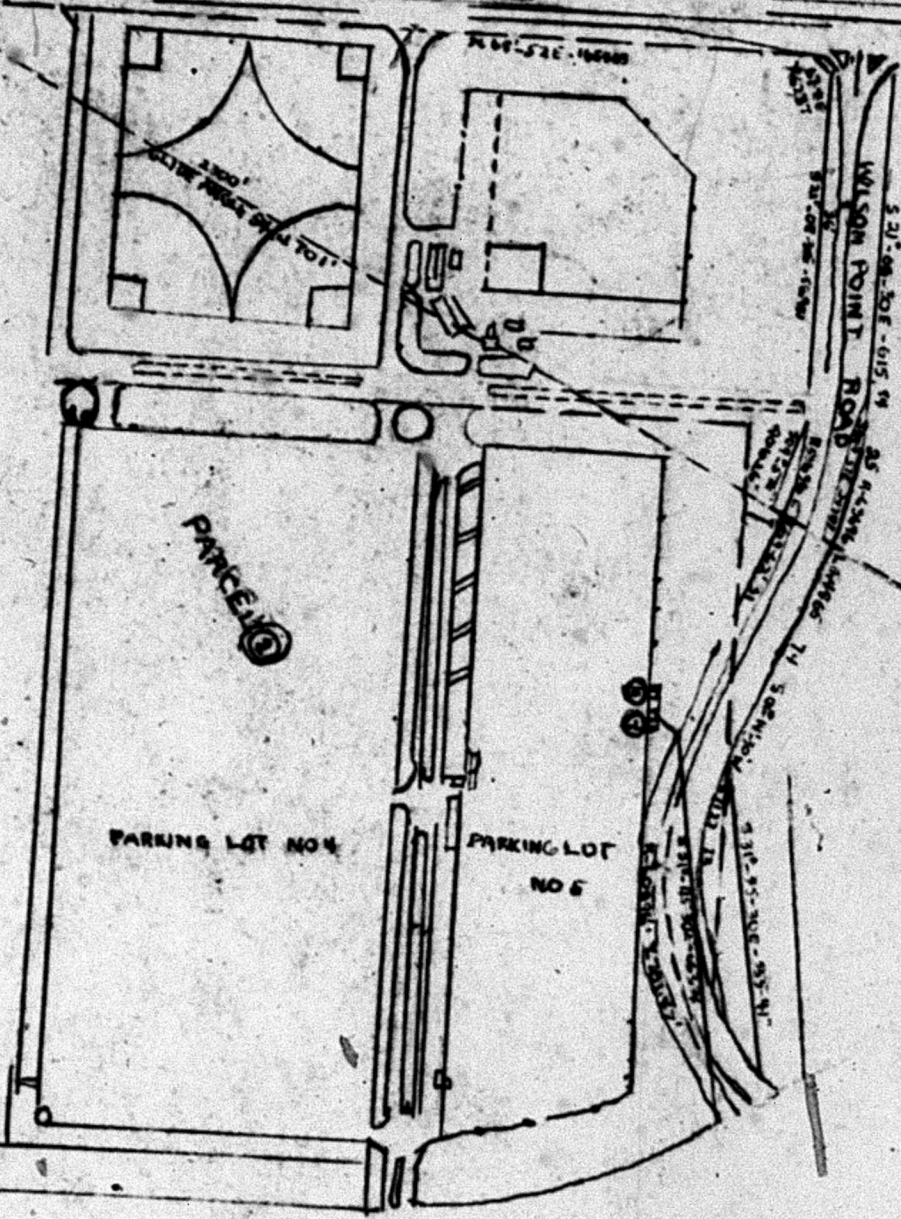

PARKING LOT NO 4

PARKING LOT NO 6

PARCEL

WILSON POINT ROAD

S 45° 00' 00" E - 140' 00" 00" W

S 21° 00' 30" E - 015' 00" 00" W

S 10° 00' 00" E - 015' 00" 00" W

S 45° 00' 00" E - 140' 00" 00" W

S 71° 00' 00" E - 015' 00" 00" W

S 15° 00' 00" E - 015' 00" 00" W