

1761-5  
#1761-5  
1761-RS  
MAP #13

PERMISSION FOR (1) ZONING RECLASSIFICATION  
(2) SPECIAL PERMIT

To the Zoning Commissioner of Baltimore County:

I, or we, Oaklea Village, Inc. Legal Owner  
of property located on the East side of Southwestern Blvd. (Wilsons  
Ave., extended to Washington Blvd.) starting 751.83 Feet North from  
Knecht Ave. with frontage of 150 feet on Southwestern Blvd. and with  
an average depth of 175 feet approximate to the Pennsylvania R.R.  
right of way.

herby petition (1) that the zoning status of the above described  
property be reclassified, pursuant to the Zoning Law of Baltimore  
County, from an "A" Residence Zone to an "B" Commercial Zone; and  
(2) for a Special Permit, under said Zoning Law and Zoning Regu-  
lations of Baltimore County, to use the above described property,  
for Gasoline Filling Station

Property to be posted as prescribed by Zoning Regulations.

I, or we, agree to pay expenses of the above reclas-  
sification and Special Permit, advertising, posting, etc., upon  
filing of this petition, and further agree to and are to be bound  
by the Zoning Regulations and Restrictions of Baltimore County, adopted  
pursuant to the Zoning Law for Baltimore County.

Edw. H. Davis  
Edw. H. Davis  
Edw. H. Davis  
President

Archibus, Maryland  
Address

7/7  
3 PM

ORDERED by the Zoning Commissioner of Baltimore  
County this 14th day of June, 1950.

that the subject matter of this petition be advertised in  
a newspaper of general circulation throughout Baltimore  
County and that the property be posted, as required by the  
Zoning Regulations and Act of Assembly aforesaid, and that a  
public hearing, thereon be had in the office of the Zoning  
Commissioner of Baltimore County, Maryland, on the 7th  
day of July, 1950, at 3:00 o'clock  
P.M.

Chas. H. Deing  
Zoning Commissioner  
of Baltimore County

Upon hearing on petition (1) for reclassification  
of the parcel of land described therein from an "A" Residence  
zone to an "B" Commercial Zone and (2) for a special permit  
to use said property for a gasoline service station and it  
appearing that by reason of location the said petition should  
be granted, therefore:

It is this 22nd day of August, 1950, ORDERED  
by the Zoning Commissioner of Baltimore County that the  
aforesaid petition be and the same is hereby granted; the  
(1) for reclassification as aforesaid and (2) for use of the  
property for a gasoline service station, subject, however,  
to the provision that the setback for the service building to  
be erected thereon and the island for the gasoline pumps,  
shall be as shown on plot plan filed.

Approved:  
County Commissioners  
of Baltimore County

By Bruce A. Lail  
President  
Date: Aug 28, 1950

June 8, 1950

\$25.00 ✓  
RECEIVED of Oak Oil Company the sum of Twenty Three  
(\$23.00) dollars, being cost of petition for special  
permit and reclassification of property, advertising and  
posting, east side of Southwestern Boulevard, 151 feet  
north of Knecht Avenue, 15th District of Balto. Co.

Zoning Commissioner  
Received  
Friday, July 7, 1950  
at 3:00 PM  
3 PM

#1761-RS  
MAP #13

REC'D JUN 20 1950

NOTICE OF ZONING RECLASSIFICATION AND PETITION FOR A SPECIAL PERMIT  
Thirteenth District

PURSUANT to petition filed with the Zoning Commissioner of Baltimore County, for change of Baltimore County, from an "A" Residence Zone to an "B" Commercial Zone of the property hereinafter described and for a SPECIAL PERMIT to use said property for a Gasoline Service Station, the Zoning Commissioner of Baltimore County, by authority of the Zoning Act and Regulations of Baltimore County, will hold a public hearing at the Zoning Office, in the Boarding Building, Town of Catonsville, Maryland, on Friday, July 7, 1950 at 3:00 P. M. to determine whether or not the following amendment and special property should be changed or reclassified as aforesaid and a Special Permit granted for a Gasoline Service Station, to wit:

All that parcel of land in the 15th District of Balto. Co., bounded on the east side by Southwestern Boulevard, (Wilsons Ave. extended to Washington Boulevard), bearing 151.83 feet north of Knecht Ave., with frontage of 150 feet on Southwestern Boulevard and with an average depth of 175 feet approximately to the Pennsylvania Railroad right-of-way; being property of Oaklea Village, Inc. as shown on plot plan filed with the Building and Zoning Department.

By Order of Chas. H. Deing, Zoning Commissioner of Baltimore County June 14, 1950

THE BALTIMORE COUNTIAN

June 24, 1950

THIS IS TO CERTIFY, that the annexed advertisement of Charles H. Deing, Zoning Commissioner of Baltimore County was inserted in THE BALTIMORE COUNTIAN, a group of three weekly newspapers published in Baltimore County, Maryland, once a week for 2 successive weeks before the 24th day of June, 1950, that is to say the same was inserted in the issues of June 14 and 23, 1950

By P. J. Morgan Editor and Manager.

CERTIFICATE OF POSTING  
ZONING DEPARTMENT OF BALTIMORE COUNTY 1761-5  
Town, Maryland

District: 13 Date of Posting: June 23/50

Posted for: Commercial & Gas Station  
Oaklea Village

Petitioner: Oaklea Village

Location of property: east side of Southwestern Boulevard  
751.83' north of Knecht Ave

Location of Sign: east side of Southwestern Boulevard  
526 feet north of Knecht Ave

Remarks: \_\_\_\_\_

Posted by: Harry E. Bartwick Date of return: June 23/50  
Inspector

June 26, 1950

The Oak Oil Company,  
2310 Russell Street,  
Baltimore 30, Maryland

Attn: Mr. Cochran

Dear Mr. Cochran:

Confirming conversation today, the date for the hearing on the petition filed by your Company for a gasoline filling station on the east side of the Southwestern Boulevard, has been set for Friday, July 7, 1950 at 3:00 P. M. and not at 11:00 A. M. as previously stated.

Very truly yours,  
Zoning Commissioner

P. R. R. 4/19

PROPERTY LINE 186.00' N 46° 31' W

PROPERTY LINE 183.00' S 61° 57' E

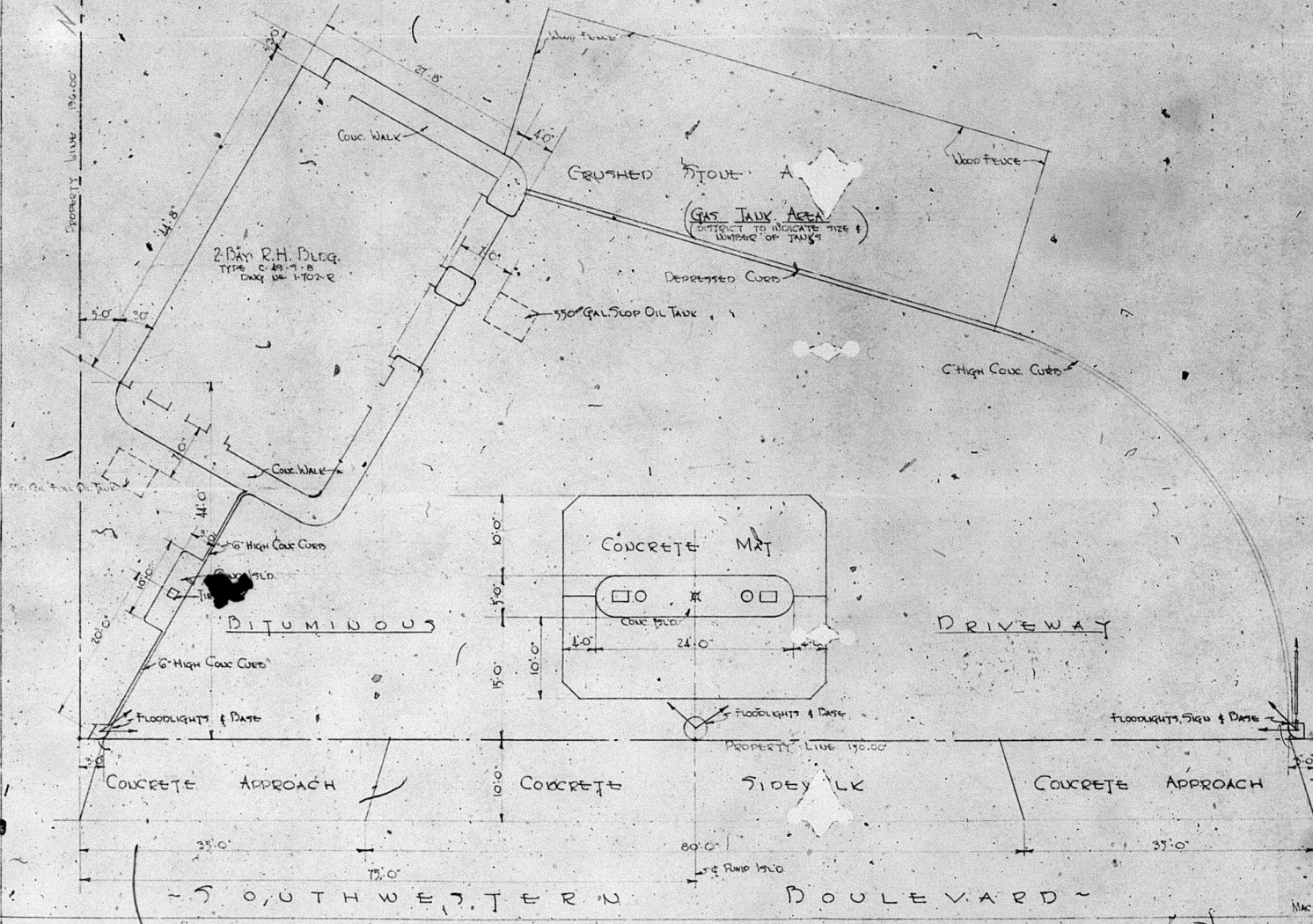

**SUN OIL COMPANY**  
 MIDDLE ATLANTIC REGION  
 ENGINEERING DEPARTMENT  
 1600 WALNUT STREET PHILADELPHIA, PA.  
 PROPOSED SERVICE STATION PLOT PLAN  
 SOUTHWESTERN BLVD. & LEEDS AVE., BALTIMORE, MD.  
 SCALE: 1/8" = 1'-0"  
 DATE: 4-3-50 DRAWN BY: PCC:AMT CHECKED:  
 DRAWING NO. SC-1038

Mac-256