

OWNED by the Zoning Commissioner of Baltimore County this 9th day of November, 1953, that the subject matter of this petition be advertised in a newspaper of general circulation throughout Baltimore County and that the property be posted, as required by the Zoning Regulations and Act of Assembly aforesaid, and that a public hearing thereon be had in the office of the Zoning Commissioner of Baltimore County, Maryland, on the 9th day of November, 1953, at 2:00 o'clock P.M.

Zoning Commissioner  
of Baltimore County

Upon hearing on petition for a Special Permit to use the property described therein for a Gasoline Service Station and it appearing that by reason of location, being in a commercial zone, the safety and general welfare of the community not being detrimentally affected, the special permit should be granted, therefore:

It is this 7th day of December, 1953, ORDERED by the Deputy Zoning Commissioner of Baltimore County that the aforesaid petition for a special permit be and the same is hereby granted, subject, however, to the setback for any buildings or structures to be erected and the island for the gasoline pumps shall be subject to the approval of the Zoning Department.

*Walter H. Cramer*  
Deputy Zoning Commissioner  
of Baltimore County

PAID & RETURNED RECEIVED  
542 E. of Kenwood Ave., Dept. 1070  
Baltimore, Md. (833-25)  
11th Dec. 1953  
2803

PETITION FOR SPECIAL PERMIT

IN THE MATTER OF :  
: BEFORE THE  
: ZONING COMMISSIONER  
: OF BALTIMORE COUNTY

For a Special Permit  
To The Zoning Commissioner of Baltimore County

Patsy Veschio and Dolores H. Veschio, his wife Legal Owner &  
Edward Kahn and Reba Kahn, his wife Contract Purchaser

herby petition for a Special Permit, Under the Zoning Regulations and Restrictions passed by the County Commissioners of Baltimore County, agreeable to Chapter 877 of the Acts of the General Assembly of Maryland of 1943, for a certain permit and use, as provided under said Regulations and Act, as follows:

A Special Permit to use the land (and improvements now or be erected thereon) hereinafter described for Gas Service Station

All that parcel of land in the 14th District of Baltimore County on the west side of Kenwood Avenue, beginning 190 feet south of Hazelwood Avenue, thence southerly on the west side of Kenwood Avenue, 150 feet with a rectangular depth westerly of 150 feet. Being property of P. Veschio as shown on the plot plan filed with the Zoning Department.

EDWARD KAHN Patsy Veschio  
Reba Kahn Dolores H. Veschio  
Contract Purchaser Legal Owner Dolores H. Veschio

2502 Eubank Place 3539 Lyndale Avenue - Baltimore 13, Md.  
Address Baltimore 13, Md. Address

11/30  
2 P.M.

2803-5  
DRA  
#11-14-A  
S.S.  
GAS STA.  
11/21/53

CERTIFICATE OF POSTING  
ZONING DEPARTMENT OF BALTIMORE COUNTY  
Towson, Maryland

District 14 # 2803  
Date of Posting 11-18-53  
Posted for Special Permit for Gasoline Service Station  
Petitioner Pat Veschio & Dolores H. Veschio  
Location of property W.S. of Kenwood Ave. by 150 ft. of Hazelwood Ave. thence S. & E. boundary on the W.S. of Kenwood Ave. 150 ft. with a rectangular depth W. of 150 ft.  
Location of Signs West side of Kenwood Ave. 265 ft. South of Hazelwood Ave.  
Remarks \_\_\_\_\_  
Posted by George C. Jefferson Date of return 11-19-53

November 13, 1953

\$20.00 RECEIVED of Pat Veschio, the sum of Twenty (\$20.00) Dollars, being cost of petition for Special Permit, advertising and posting property, west side of Kenwood Avenue, beginning 190 feet south of Hazelwood Avenue, 14th District, Baltimore County, Md.

Zoning Commission

FILED NOV 23 1953

CERTIFICATE OF PUBLICATION

TOWSON, MD. November 20, 1953

THIS IS TO CERTIFY, That the annexed advertisement was published in THE JEFFERSONIAN, a weekly newspaper printed and published in Towson, Baltimore County, Md. before at 2 P.M. November 20, 1953 before the 30th day of November, 1953 the first publication appearing on the 15th day of November, 1953.

THE JEFFERSONIAN.

*H. Jefferson*  
Manager.

Cost of Advertisement, \$.....

ZONING DEPARTMENT OF BALTIMORE COUNTY  
TOWSON, MD. NOV 23 1953  
RECEIVED OF PAT VESCHIO, THE SUM OF TWENTY (\$20.00) DOLLARS, BEING COST OF PETITION FOR SPECIAL PERMIT, ADVERTISING AND POSTING PROPERTY, WEST SIDE OF KENWOOD AVENUE, BEGINNING 190 FEET SOUTH OF HAZELWOOD AVENUE, 14TH DISTRICT, BALTIMORE COUNTY, MD.

PAID  
NOV 13 1953  
COUNTY COMMISSIONERS  
OF BALTIMORE COUNTY  
By *J. Cramer*

**LIGHTS.**  
 A-BENJAMIN FLOOD LIGHTS (2) No. 57GG WITH 1000 W. LAMPS ATOP SIGN POLE.

D-BENJAMIN FLOOD LIGHTS (2) No. 57GG WITH 1000 W. LAMPS ATOP KEVVEE STANDARD No. 1978 (20FT).

C-REVERSE PY LOW-LITE No. 1965 WITH REVERSE ISLAND LIGHT No. 3018 GREEN WITH 500 W. LAMP

D-SAME AS LIGHT C EXCEPT USE REVERSE PY LOW-LITE No. 1965-A. - INSTALL 20FT AIR HOSE & #10-A SCHRADER CHUCK GAUGE.

E-SAME AS LIGHT C BUT ADD 3 #32BI REVERSE HOLDERS WITH 3 PAR 38-150 W. SPOTS.

F-SAME AS LIGHT D BUT ADD 3 #32BI REVERSE HOLDERS WITH 3 PAR 38-150 W. SPOTS.

**NOTE: ALL LIGHTS MENTIONED ABOVE TO BE BY OTHERS.**

**LEGEND**

- UNDERGROUND ELECT LINES ———— E
- UNDERGROUND AIR LINES (1/2") ———— A
- U.G. SUCTION LINES ———— S
- U.G. VENT LINES ———— V
- C.P. — CONC. PLATF.
- U.G. — UNDERGROUND
- EXIST. ELEVATIONS ———— EL. O. 00
- PROPOSED ELEVATIONS (FIN. GR.) EL. O. 00
- (1) - BETHOLINE PUMP BY OTHERS.
- (2) - SUCCLAIR PUMP BY OTHERS.
- (3) - 2000 GAL. U.S. GASOLINE (BETHOLINE) STORAGE TANK BY OTHERS.
- (4) - 2000 GAL. U.S. GASOLINE (SUCCLAIR) STORAGE TANK BY OTHERS.
- (5) - 550 GAL. U.S. WASTE OIL TANK BY OTHERS.
- (6) - 550 GAL. U.S. KEROSENE TANK BY OTHERS.
- (7) - 550 GAL. U.S. FUEL OIL TANK.

**GENERAL NOTES**

- A-INSTALL CONC. CURB & GUTTER IN ACCORDANCE WITH LOCAL REGULATIONS.
- B-INSTALL OUTLET FOR FAST BATTERY CHARGER SEE NOTE 2 - DRAWING No. 3
- C-INSTALL ONE GAL. LOW STROKE KEROSENE PUMP BY OTHERS.
- D-INSTALL 24"x24"x1" REIN. CONC. SLAB AT ALL TANK FILLS. EXP. JUNT ALL AROUND. USE 1/2" & DIES 8" & BOTHWAYS.
- E-HOODS ATOP VENT LINES. BOTTOM OF HOODS TO BE 12" ABOVE ROOF LINE.
- F-INSTALL ANTI-FREEZE HYD. CONNECT TO WATER SUPPLY WITH 1" PIPES.
- G-1" HOLE THRU CONC. PLATF. & LUBE WALL. BOTTOM OF HOLES TO BE FLUSH WITH TOP OF FIN. DRIVEWAY & TOP OF FIN. LUBE FLOOR.
- H-INSTALL SEPTIC TANK IN ACCORDANCE WITH LOCAL REGULATIONS.
- J-INSTALL LEACHING CHAMBER IN ACCORDANCE WITH LOCAL REGULATIONS. INSTALL 1" THICK REIN. CONC. (12"x4") SLAB ATOP CHAMBER. USE 1/2" DIES 8" & BOTHWAYS. CONTRACTOR TO MAKE SOIL TESTS BEFORE STARTING ANY WORK.
- K-INSTALL JOSEPH FLOOR DR. (C-1) No. 554.
- L-RUN ONE 1" & ELECTRIC CONDUIT TO SIGN POLE EACH PUMP TO HAVE A SEPARATE CIRCUIT.

**SPECIAL NOTES**

THE CONTRACTOR SHALL CHECK & VERIFY ALL DIMENSIONS SHOWN ON THESE DRAWINGS BEFORE STARTING ANY WORK.  
 THE COST OF ANY CHANGE OR ADDITIONAL WORK, SUCH AS RELOCATING OR INSTALLING ADDITIONAL DRAINS, INLETS OR PIPES REQUIRED BY LOCAL AUTHORITIES OR UTILITY COMPANIES IN ORDER TO PERFORM THE WORK AS SHOWN ON PLAT PLAN SHALL BE INCLUDED IN THE CONTRACTOR'S BID.

**PLOT PLAN**

SHERWOOD BROTHERS INCORPORATED  
 PETROLEUM PRODUCTS  
 10 LIGHT ST. BALTO. 2, MD.  
 ENGINEERING DEPARTMENT  
 TWO SHALL SERVICE STA. STANDARD TYPE  
 SHERWOOD 211 - LOC. WEST SIDE OF  
 KEENWOOD AVE. 100 FT. S. OF HAZELWOOD AVE.  
 HAZELWOOD TWP. CALHOUN CO. MD. BY PUECHIO  
 DRAWN BY: G. J. S. DATE: 10/5/53  
 APPROVED BY: W. E. S. DATE: 10/5/53  
 CHECKED BY: B. K. G. DATE: L.F.P.

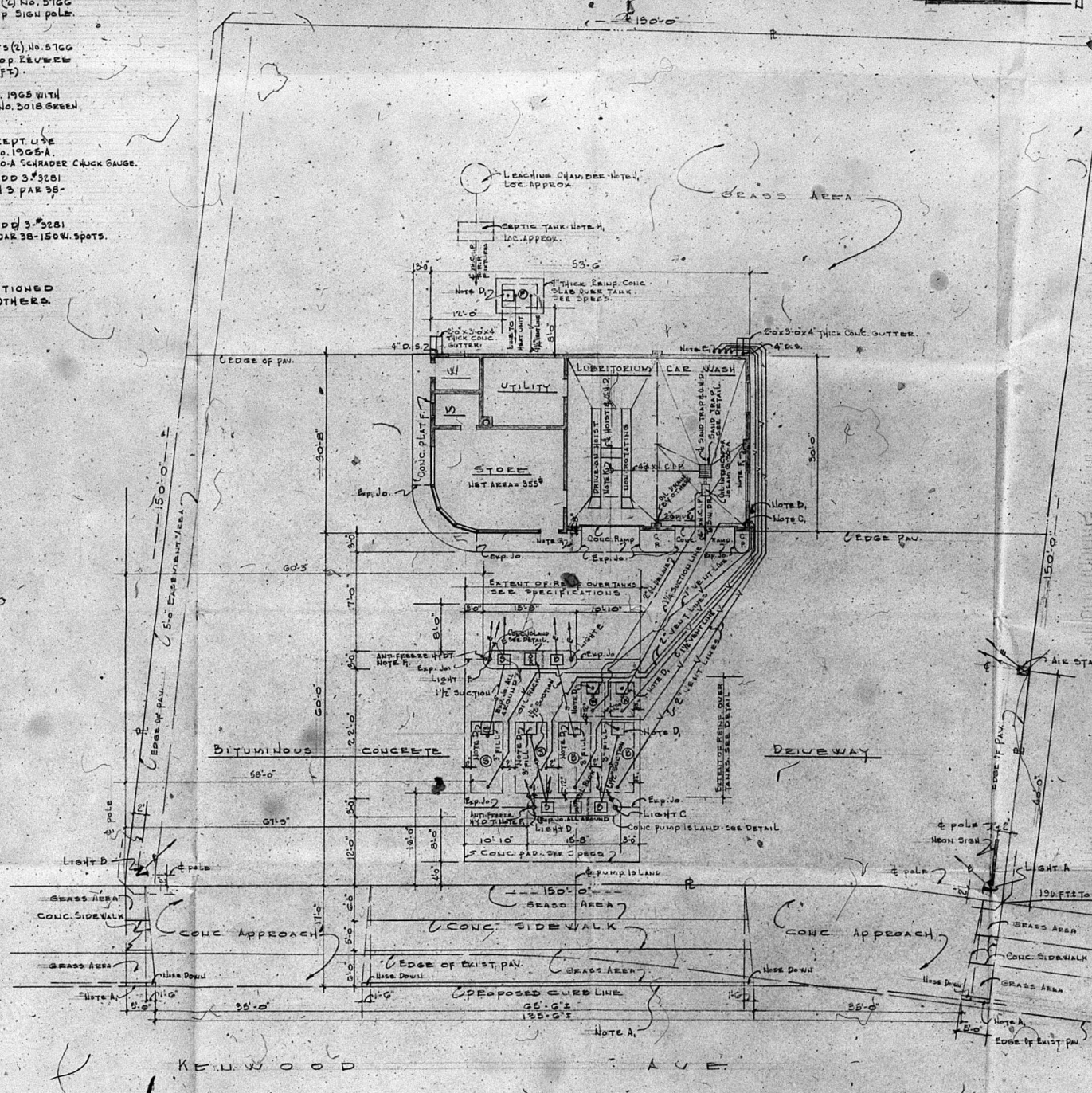

KEENWOOD AVE.