

Job # 0673987
ASD, FOR

JOS
or
WRY

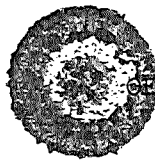

APPLICATION FOR PERMIT
BALTIMORE COUNTY MARYLAND
OFFICE OF THE BUILDING ENGINEER
TOWSON, MARYLAND 21204

RECEIVED
MAY 28 1998
OFFICE OF PLANNING

DATE: 4-22-98
OEA: JMMR
HISTORIC DISTRICT/BLDG.

PERMIT #: B
RECEIPT #: 4
CONTROL #: NR.
XREF #:

PROPERTY ADDRESS: 6932 Gunpowder Lane
SUBDIV: Twin River Reach - Birch River
TAX ACCOUNT #: 15-13-206560
OWNER'S INFORMATION (LAST, FIRST): 15 6
NAME: STARR MARY M.
ADDR: 205 EAST TIMONIUM RD. 21093

FEE: 149.00 + 5.00
PAID: 154.00
PAID BY:
INSPECTOR:

DOES THIS BLDG. HAVE SPRINKLERS
YES NO

I HAVE CAREFULLY READ THIS APPLICATION AND KNOW THE SAME IS CORRECT AND TRUE, AND THAT IN DOING THIS WORK ALL PROVISIONS OF THE BALTIMORE COUNTY CODE AND APPROPRIATE STATE REGULATIONS WILL BE COMPLIED WITH WHETHER HEREIN SPECIFIED OR NOT AND WILL REQUEST ALL REQUIRED INSPECTIONS.

APPLICANT INFORMATION
NAME: LLOYD A. HARRIS
COMPANY: LLOYDS HOME SALES INC.
STREET: 1105 MOUNTAIN RD.
CITY, ST, ZIP: JOPPA MD. 21085
PHONE #: 410-679-4141 MHIC LICENSE #: 19376
APPLICANT SIGNATURE: Lloyd A. Harris TRACT: _____ BLOCK: _____
PLANS: CONST 12 PLOT 17 PLAT _____ DATA _____ EL 1 PL 1
TENANT: _____
CONTR: Lloyds Home Sales Inc.
ENGR: _____
SELLR: _____

BUILDING CODE or 2 FAM. CODE
BOCA CODE

- TYPE OF IMPROVEMENT
- 1. NEW BLDG CONST
 - 2. ADDITION
 - 3. ALTERATION
 - 4. REPAIR
 - 5. WRECKING
 - 6. MOVING
 - 7. OTHER

DESCRIBE PROPOSED WORK:

TYPE OF USE: Panel 315A Construct Foundation For + Erect A state Approved Industrialized Dwelling. 3-Bdrms, Zone "A" 1012

- RESIDENTIAL Zone "A" 1012 NON-RESIDENTIAL 26'x56'x16' = 1,456#
- 01. ONE FAMILY
 - 02. TWO FAMILY
 - 03. THREE AND FOUR FAMILY
 - 04. FIVE OR MORE FAMILY (ENTER NO UNITS)
 - 05. SWIMMING POOL
 - 06. GARAGE
 - 07. OTHER
 - 08. AMUSEMENT, RECREATION, PLACE OF ASSEMBLY
 - 09. CHURCH, OTHER RELIGIOUS BUILDING
 - 10. FENCE (LENGTH HEIGHT)
 - 11. INDUSTRIAL, STORAGE BUILDING
 - 12. PARKING GARAGE
 - 13. SERVICE STATION, REPAIR GARAGE
 - 14. HOSPITAL, INSTITUTIONAL, NURSING HOME
 - 15. OFFICE, BANK, PROFESSIONAL
 - 16. PUBLIC UTILITY
 - 17. SCHOOL, COLLEGE, OTHER EDUCATIONAL
 - 18. SIGN
 - 19. STORE MERCANTILE RESTAURANT SPECIFY TYPE _____
 - 20. SWIMMING POOL SPECIFY TYPE _____
 - 21. TANK, TOWER
 - 22. TRANSIENT HOTEL, MOTEL (NO. UNITS _____)
 - 23. OTHER

- TYPE FOUNDATION
- 1. SLAB
 - 2. BLOCK
 - 3. CONCRETE
 - BASEMENT
 - 1. FULL
 - 2. PARTIAL
 - 3. NONE

TYPE OF CONSTRUCTION

- 1. MASONRY
- 2. WOOD FRAME
- 3. STRUCTURE STEEL
- 4. REINF. CONCRETE

TYPE OF HEATING FUEL

- 1. GAS
- 2. OIL
- 3. ELECTRICITY
- 4. COAL

TYPE OF SEWAGE DISPOSAL

- 1. PUBLIC SEWER EXISTS PROPOSED
- 2. PRIVATE SYSTEM EXISTS PROPOSED
- SEPTIC EXISTS PROPOSED
- PRIVY EXISTS PROPOSED

CENTRAL AIR: 1. 2.
ESTIMATED COST: \$ 3000
OF MATERIALS AND LABOR

PROPOSED USE: Residential
EXISTING USE: _____

OWNERSHIP
1. PRIVATELY OWNED 2. PUBLICLY OWNED 3. SALE 4. RENTAL

RESIDENTIAL CATEGORY: 1. DETACHED 2. SEMI-DET. 3. GROUP 4. TOWNHSE 5. MIDRISE
#EFF: #1BED: 3 #2BED: 3 #3BED: 1 TOT BED: 7 TOT APTS/CONDOS: _____ 6. HIRISE
GARBAGE DISPOSAL 1. 2. N BATHROOMS 2 CLASS 3A
POWDER ROOMS 0 KITCHENS 1 LIBER 410569 FOLIO 540 33

BUILDING SIZE LOT SIZE AND SETBACKS
FLOOR 1,456 SIZE 11,905
WIDTH 36' 26" FRONT STREET 131'
DEPTH 36' 56" SIDE STREET _____
HEIGHT 16' FRONT SETBK 34'
STORIES 1 SIDE SETBK 12' 12"
LOT # 85,86 SIDE STR SETBK _____
NEAR LOT REAR SETBK 131'
Y 2. N ZONING DR 5.5

APPROVAL SIGNATURES DATE
BLD INSP : _____ : _____
BLD PLAN : 170 : _____
FIRE : _____ : _____
SEDI CTL : 410569-1-1-1 : 4-24-98
ZONING : DR 5.5 : 4-24-98
PUB SERV : _____ : _____
ENVRMNT : 410569-1-1-1 : 4-24-98
PERMITS : _____ : _____

MAKE CHECKS PAYABLE TO BALTIMORE COUNTY MARYLAND -- NO PERMIT FEES REFUNDED

of Acknt. provided to be signed
(LIMITED CITED LOT COMPATIBILITY REFORM)

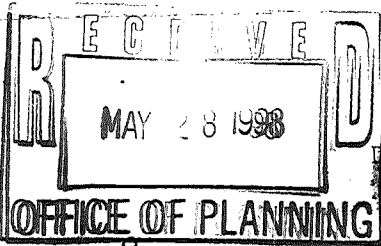

APPLICATION FOR PERMIT
BALTIMORE COUNTY MARYLAND
DEPARTMENT OF PERMITS & DEVELOPMENT MANAGEMENT
TOWSON, MARYLAND 21204

DATE: 4-22-98

OEA: 15A
HISTORIC DISTRICT/BLDG.

PERMIT #: B
RECEIPT #: A
CONTROL #: RA
XREF #:
FEE: 100
PAID:
PAID BY: App'l
INSPECTOR: [Signature]

PROPERTY ADDRESS 6932 Gander Ave YES NO
SUITE/SPACE/FLOOR _____ DO NOT KNOW
SUBDIV: Twin River Beach
TAX ACCOUNT #: 15-13-206560 DISTRICT/PRECINCT 15 6
OWNER'S INFORMATION (LAST, FIRST) _____
NAME: STARR MARY
ADDR: 205 EAST TIMONIAN RD. 21093

DOES THIS BLDG. HAVE SPRINKLERS
YES ___ NO ___

I HAVE CAREFULLY READ THIS APPLICATION AND KNOW THE SAME IS CORRECT AND TRUE, AND THAT IN DOING THIS WORK ALL PROVISIONS OF THE BALTIMORE COUNTY CODE AND APPROPRIATE STATE REGULATIONS WILL BE COMPLIED WITH WHETHER HEREIN SPECIFIED OR NOT AND WILL REQUEST ALL REQUIRED INSPECTIONS.

BUILDING 1 or 2 FAM.
CODE CODE _____
BOCA CODE
TYPE OF IMPROVEMENT
1. ___ NEW BLDG CONST
2. ___ ADDITION
3. ___ ALTERATION
4. ___ REPAIR
5. WRECKING
6. ___ MOVING
7. ___ OTHER _____

TYPE OF USE
RESIDENTIAL
01. ONE FAMILY
02. ___ TWO FAMILY
03. ___ THREE AND FOUR FAMILY
04. ___ FIVE OR MORE FAMILY
(ENTER NO UNITS) _____
05. ___ SWIMMING POOL
06. ___ GARAGE
07. ___ OTHER _____

TYPE FOUNDATION
1. ___ SLAB
2. ___ BLOCK
3. ___ CONCRETE

BASEMENT
1. ___ FULL
2. ___ PARTIAL
3. ___ NONE

APPLICANT INFORMATION
NAME: Lloyd A. Harris
COMPANY: Lloyd's Home Sales Inc.
STREET: 1165 MTN RD.
CITY, ST, ZIP: Joppa MD 21085
PHONE #: 410-679-4141 MHIC LICENSE #: 19376
APPLICANT SIGNATURE: Lloyd A. Harris DRC# _____
PLANS: CONST PLOT _____ PLAT _____ DATA _____ EL 2 PL 2
TENANT _____
CONTR: Spencer, Inc
ENGR: _____
SELLR: _____

DESCRIBE PROPOSED WORK: Raze Ex SFD. To Be Torn Down. Debris To Be Hauled To Approved Sanitary Landfill In Accordance With Applicable Baltimore County Site Regulations. Sewer To Be Capped. Permit Expires 90 Days From Date Of Issue. Hse Built 1920's

- 08. ___ AMUSEMENT, RECREATION, PLACE OF ASSEMBLY
- 09. ___ CHURCH, OTHER RELIGIOUS BUILDING
- 10. ___ FENCE (LENGTH _____ HEIGHT _____)
- 11. ___ INDUSTRIAL, STORAGE BUILDING 44'x16' = 704 sq ft
- 12. ___ PARKING GARAGE
- 13. ___ SERVICE STATION, REPAIR GARAGE
- 14. ___ HOSPITAL, INSTITUTIONAL, NURSING HOME
- 15. ___ OFFICE, BANK, PROFESSIONAL See B
- 16. ___ PUBLIC UTILITY
- 17. ___ SCHOOL, COLLEGE, OTHER EDUCATIONAL Far New SFD.
- 18. ___ SIGN
- 19. ___ STORE _____ MERCANTILE _____ RESTAURANT _____
SPECIFY TYPE _____
- 20. ___ SWIMMING POOL _____
SPECIFY TYPE _____
- 21. ___ TANK, TOWER
- 22. ___ TRANSIENT HOTEL, MOTEL (NO. UNITS _____)
- 23. ___ OTHER _____

TYPE OF CONSTRUCTION
1. ___ MASONRY
2. ___ WOOD FRAME
3. ___ STRUCTURE STEEL
4. ___ REINF. CONCRETE

TYPE OF HEATING FUEL
1. ___ GAS 3. ___ ELECTRICITY
2. ___ OIL 4. ___ COAL

TYPE OF SEWAGE DISPOSAL
1. PUBLIC SEWER EXISTS PROPOSED
2. ___ PRIVATE SYSTEM EXISTS PROPOSED
SEPTIC EXISTS PROPOSED
PRIVY EXISTS PROPOSED

CENTRAL AIR: 1. ___ 2. ___
ESTIMATED COST: \$ _____

TYPE OF WATER SUPPLY
1. PUBLIC SYSTEM EXISTS PROPOSED
2. ___ PRIVATE SYSTEM EXISTS PROPOSED

OF MATERIALS AND LABOR
PROPOSED USE: VACANT
EXISTING USE: SFD

OWNERSHIP
1. PRIVATELY OWNED 2. ___ PUBLICLY OWNED 3. ___ SALE 4. ___ RENTAL

RESIDENTIAL CATEGORY: 1. DETACHED 2. ___ SEMI-DET. 3. ___ GROUP 4. ___ TOWNHSE 5. ___ MIDRISE
#EFF: #1BED: ___ #2BED: ___ #3BED: ___ TOT BED: ___ TOT APTS/CONDOS: ___ 6. ___ HIRISE
1 FAMILY BEDROOMS
GARBAGE DISPOSAL 1. Y 2. ___ N BATHROOMS _____ CLASS 34
POWDER ROOMS _____ KITCHENS _____ LIBER 09 FOLIO 33

BUILDING SIZE
FLOOR 704
WIDTH _____
DEPTH _____
HEIGHT _____
STORIES _____
LOT #'S _____
CORNER LOT _____
1. ___ Y'S 2. ___ N ZONING _____

LOT SIZE AND SETBACKS
SIZE 50' wide
FRONT STREET _____
SIDE STREET _____
FRONT SETBK _____
SIDE SETBK ANC
SIDE STR SETBK
REAR SETBK _____

APPROVAL SIGNATURES _____ DATE _____
BLD INSP : _____ : _____
BLD PLAN : _____ : _____
FIRE : _____ : _____
SEDI CTL : _____ : _____
ZONING : [Signature] : 4/24/98
PUB SERV : [Signature] : 4/24/98
ENVRMNT : [Signature] : 4-24-98
PERMITS : _____ : _____
Rm 406 NC OK TO ISSUE 4-24-98

MAKE CHECKS PAYABLE TO BALTIMORE COUNTY MARYLAND -- NO PERMIT FEES REFUNDED

* Cert. of Acknt. provided. (To be signed) [Signature]

N 28,000

BIRD RIVER

N 31,000

N.E. 8-M

1" = 200'

(SHEET N.E. 8-L)

N 30,000

N 29,000

N 28,000

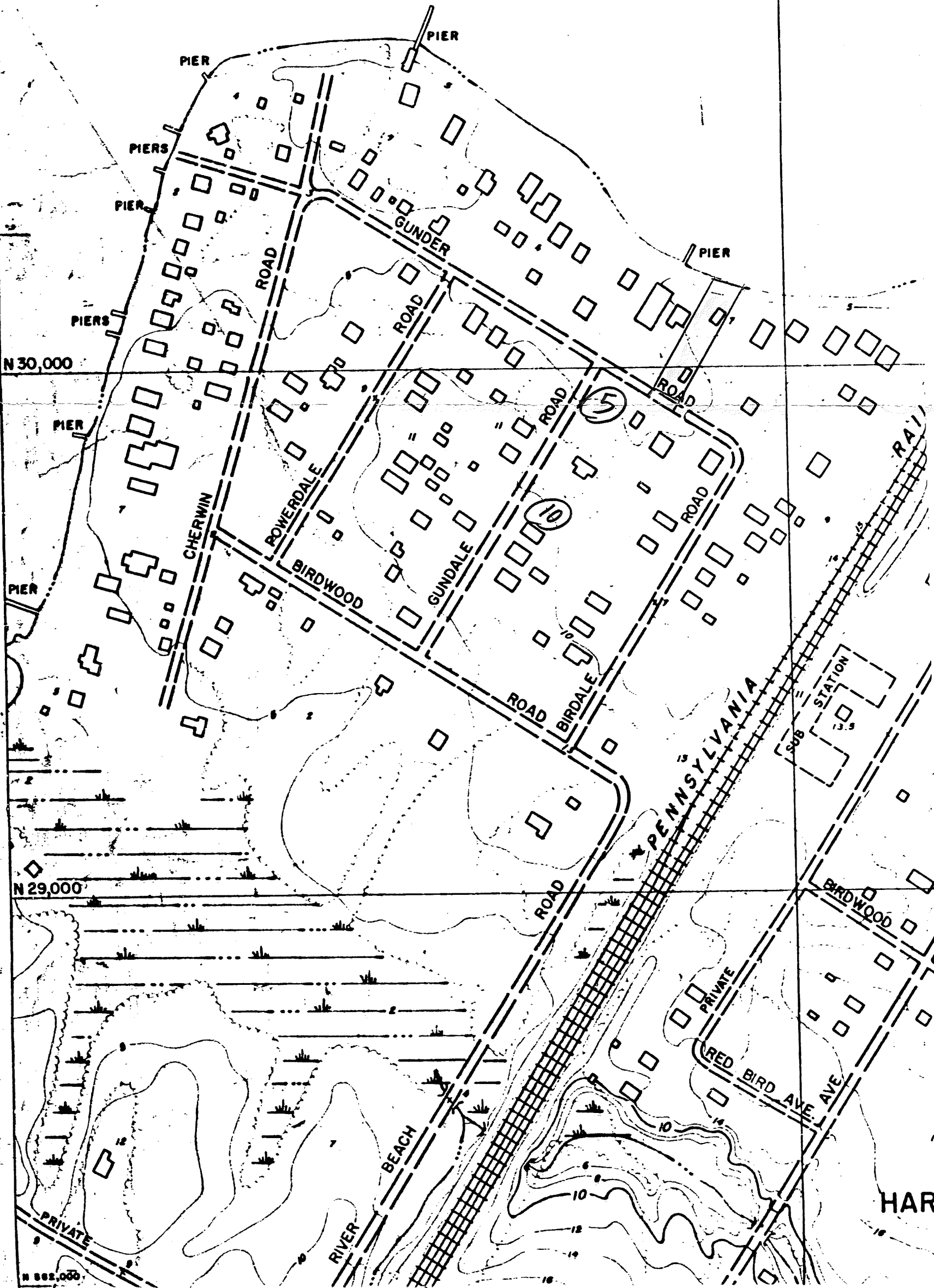

HAR

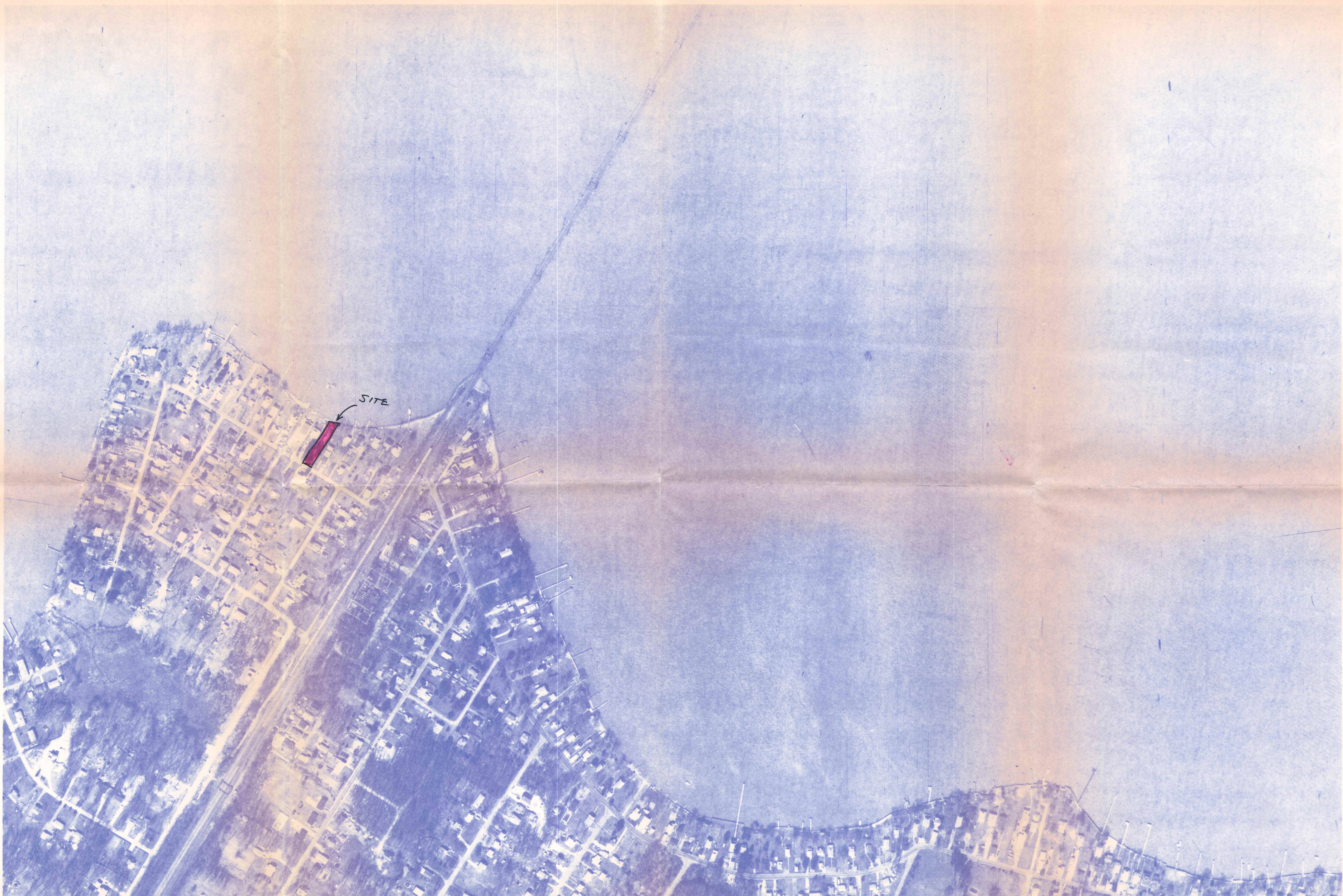

SITE



BALTIMORE COUNTY
OFFICE OF PLANNING AND ZONING
PHOTOGRAPHIC MAP

PREPARED BY AIR PHOTOGRAPHICS, INC.
MARTINSBURG, W.V. 25401

SCALE
1" = 200' ±

LOCATION

SHEET

DATE
OF
PHOTOGRAPHY
JANUARY
1986

HAREWOOD

N.E.
8-M

