

USE PERMIT



IT IS ORDERED by the Director of the Baltimore County Department of Permits and Development Management, this 13 of SEPTEMBER, 2004, that 2108 LUKEWOOD DR. (street address) should be and the same is hereby granted permission to operate a CLASS A GROUP CHILD CARE CENTER MAX. 12 CHILDREN

34541
Permit No.

Jeffery Kotroco
Director

Planner's Initials LTM

ZONING USE PERMIT
 PLAN for CLASS "A"
 CHILD CARE CENTER *

- UP TO 12 CHILDREN
- HOURS OF OPERATION
 6AM TO 6PM

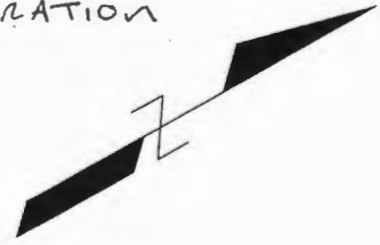

located at
 2108 LUKEWOOD DRIVE
 WINDSOR MILL, MD 21207
 2nd ELEC. DIST.

Property Owner: Priestly H. Shuler
 Statesburg S. Shuler * AS AN ACCESSORY USE
 Address: 2108 Lukewood Drive
 Windsor Mill, Maryland 21207
 Date: 04/05/04 (plan date)
 Phone: 410-277-0299
 DR 5.5=

Lot Size: 111'-0"x60'-0"; 6,660 sq/ft
 Zoning Map N 51 15 F
 Zone DR 5.5

Parking: 1 space per teacher/employee

All parking uses shown
 existed prior to the date of this plan.

Existing Floor areas Sq/ft
 1st floor 1030 sq/ft
 2nd floor 479 sq/ft
 Total= 1509 sq/ft
 Basement for Child Care Center
 Usage: 1030 sq/ft
 Existing Garage - N/A

NOTE & CHECK ONE

THERE HAVE BEEN →
 THERE HAVE NOT BEEN →

EXTERIOR ENLARGEMENTS
 TO THIS BUILDING IN THE
 PAST FIVE YEARS.

IF THERE HAVE BEEN EXPLAIN WHAT THEY WERE:
 EXPLANATION OF GROUND FLOOR ENLARGEMENTS
 HERE: _____

IF MORE THAN EXISTING PORTCH ENCLOSURE OR
 ADDITION OF EXTERIOR STAIR SHOW CALCULATIONS
 FOR THE % OF INCREASE HERE: _____

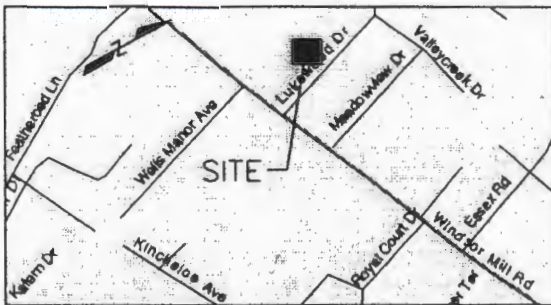
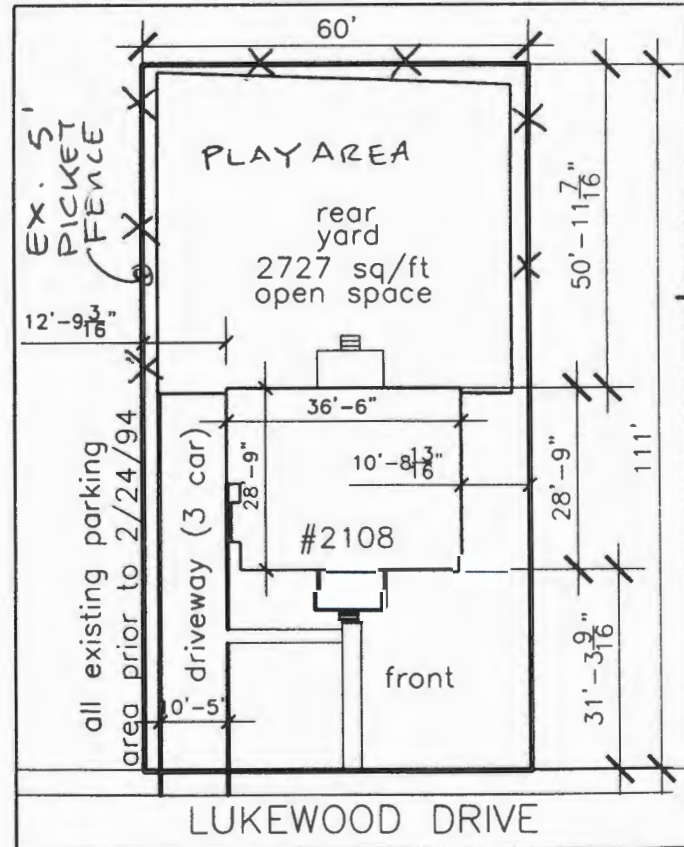

VICINITY MAP

This building has not been originally constructed to accommodate elderly housing or an assisted living facility. No reconstruction, relocation, (exterior) changes or additions (of 25% or more in ground floor area) to the exterior of the building (beyond the enclosure of a porch or the addition of an exterior stairway) have occurred within five years of the date of this permit application

1" = 30'

NO SIGNS ARE PROPOSED, ANY FUTURE SIGNS WILL COMPLY WITH SECT 413.1 BCZR AND ZONING SIGN POLICIES OR BE VARIANCED

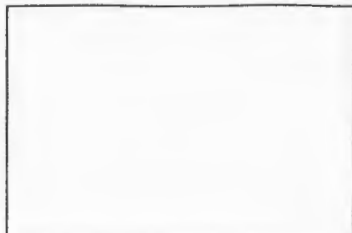

THE UNDER SIGNED ARE RESPONSIBLE FOR THE
 ACCURACY OF THE INFORMATION ON THIS PLAN (OWNERS)

PRINT OR TYPE NAME _____

SIGNATURE: *Mauldin Shuler*

PRINT OR TYPE NAME _____

SCHEDULED DATES, CERTIFICATE OF FILING AND POSTING
FOR A CLASS A CHILD CARE CENTER USE PERMIT

The application for your proposed Class A Child Care Center has been reviewed and is accepted for filing by LLOYD MOXLEY on 4/6/04.
DATE (A)

A sign indicating the proposed Child Care Center must be posted on the property for thirty (30) days before a decision can be rendered. ~~Total cost, which includes application fee and posting, is \$75.00.~~

In the absence of a request for a public hearing during the 30-day posting period, a decision can be expected within approximately five weeks.

*SUGGESTED POSTING DATE 4/13/04
B (A + 7 DAYS OR NEXT FRIDAY)

DATE POSTED 4/13/04 ←
C (CERTIFIED BELOW)

HEARING REQUESTED - YES _____ NO _____ - DATE _____

LAST DAY FOR HEARING REQUESTS 5/13/04
D (C + 30 DAYS)

APPROXIMATE DECISION DATE 5/17/04
E (A + 40 DAYS OR D + 5 WORK DAYS)

*Within 14 days of filing

=====

C E R T I F I C A T E O F P O S T I N G

District _____

Location of Property: _____

Number of Signs: _____ Date of Posting: _____

Posted by: _____

Certificate Of Posting

RE: Case NO.: 4A

Petitioner/Developer: _____
MARLYN SHULKE

Date of Hearing/Closing: 5/13/04

Baltimore County Department of
Permits and Development Management
County Office Building, Room 111
111 West Chesapeake Avenue
Towson, MD 21204

Attention:

Ladies and Gentlemen:

This letter is to certify under the penalties of perjury that the necessary
sign(s) required by law were posted conspicuously on the property
at 2108 LUXEMWOOD DR

This sign(s) were posted on 4 13 04
(Month, Day, Year)

Sincerely,

Martin Ogle
(Signature of Sign Poster and Date)

Martin Ogle
(Printed Name)

5016 Castlestone Drive

(Address)

Balto, MD 21237

(City, State, Zip Code)

(410)-933-9470

(Phone Number)



Martin Ogle
April 13, 2004

Original
Pink Receipt filed away
with other receipts.

BALTIMORE COUNTY, MARYLAND
OFFICE OF BUDGET & FINANCE
MISCELLANEOUS RECEIPT

No. 34541

DATE 4/6/04 ACCOUNT 0001 006 6150

AMOUNT \$ 50.00

RECEIVED FROM: LARRYLYN SHULER

FOR: USE PERMIT

PAID RECEIPT

| BUSINESS | ACTUAL | TIME | DRW |
|----------------------------|-----------|-------------------------|-----------|
| 4/06/2004 | 4/06/2004 | 09:52:05 | 4 |
| REG WSO6 | WALKIN | KMCH KXH | |
| >>RECEIPT # | 248137 | 4/06/2004 | OFLN |
| Dept | 5 | 528 ZONING VERIFICATION | |
| CR NO. | 034541 | | |
| Recpt Tot | | \$50.00 | |
| \$50.00 | CK | | \$.00 CA |
| Baltimore County, Maryland | | | |

Baltimore County Zoning Review Request

To: Timothy Kotroco, Director
Permits & Development
Management
Room 111, Co. Office Bldg.
111 West Chesapeake Avenue
Towson, Maryland 21204
Telephone - 410-887-3391

NOTICE TO APPLICANT: Please be aware
Section 424 Balto. Co. Zoning Regulations
controls these uses. If you are not certain
of the requirements necessary for complying
with these regulations, please contact the
P.D.M. Office before submitting this form.

A NEW CHILD CARE CENTER LICENSE has been requested for the following facility:

NAME OF CENTER: ARE you my Mommy INC

ADDRESS OF CENTER: 2108 Lukenwood Dr.

NAME OF APPLICANT/LICENSEE: MARILYN SHULER

TELEPHONE: (410) 277-0299

EXISTING USE OF BUILDING Home

IF NEW BUILDING, PROPOSED USE _____
COUNTY BUILDING AND/OR CHANGE OF USE/OCCUPANCY PERMIT NUMBER _____
(non-residential only)

PROPOSED CHILD CARE USE: CHECK ONE
Class A Group Child Care (9-12 Children)
Class B Group Child Care (13 or More Children) _____
Nursery School _____

Along with this form the following information is required for zoning review. Completing this form does not guarantee zoning approval. Other information or particular requirements may be necessary.

1. IF ANY, list zoning history/zoning hearing case numbers or prior zoning approval actions relating to the child care use: _____

Provide photocopies of the latest zoning public hearing order, use permit or letter.

2. Provide an as-built scaled site plan (1 inch = 30 FT or larger) with existing and proposed uses shown and street vicinity map showing the location and outline of the site. Show all fence requirements to comply with Section 424.1.B (BCZR) for fences abutting residential property.

3. Provide a copy of the 1" = 200' scale official zoning map* with the adjacent street names, site, and building outlines and all uses and play areas drawn to scale and properly identified. Also identify all existing and proposed uses on adjacent properties and note if any child care uses exist on these adjacent properties. *Copy available at the P.D.M. (Zoning Review) information counter during normal working hours.

4. Provide a \$50 review fee (money order or check, fee subject to change without notice) made payable to Baltimore County, Maryland.

After review, please complete the following and send to the Child Care Administration at the address listed below:
CCA, Region III
409 Washington Avenue
Suite LL8
Towson, Maryland 21204

Mail Stop 64

A CHILD CARE CENTER MAY OPERATE AT THE ABOVE-NAMED ADDRESS:
Yes No _____ (If No, please specify the grounds for disapproval and additional action required of the applicant.)

* 12 CHILDREN
MAX.
NAME/TITLE DIRECTOR P.D.M.
(Please print)
SIGNATURE LTM [Signature] Timothy Kotroco
DATE: 9/13/04

UP-2004-0001-CC