

APPLICATION FOR CHILD CARE CENTER

USE PERMIT

This Use Permit is requested in accordance with Sections 424.5 and 500.4 of the Baltimore County Zoning Regulations.

Proposed Child Care Center Location:

Election District 14
Subdivision John K. Culvers (Plat Book 4 Folio 36)
Street Address 2 Glenmore RD. AVE 21206
Lot Number 11, 12, 13 Block Number —
*If no lot or block number, give distance to nearest intersecting street _____ feet, north / south / east / west of Street / Road / Avenue
Lot Size 75' x 120'

Existing Nearest Child Care Center Location: (lot number, street address, etc.)

Teddy Bear Day Care • 7 mi No lot #
7303 Belair Rd Map 081, grid 015, parcel 0887
Baltimore, MD 21206
410-663-5800

General Information:

- A. Name and Address of Applicant/Operator
Kimberly LaValley owner/operator
5926 Clayton AVE
Baltimore MD. 21206 Telephone Number 410 866 5255
- B. Number of Employees 2 Hours of Operation 7:00 AM - 5:30 PM
Days of Week M - F
- C. Number of Children Enrolled 12
- D. Estimated Amount of Traffic Generated:
Morning 25-30 cars Afternoon 25-30 cars side street low traffic pattern
- E. Site Plan, drawn to scale, indicating location and type of structure on lot in question, location and dimensions of play parking area(s) arrangement, and proximity of dwellings on adjacent lots must accompany this Use Permit
- F. Snapshot of the Structure

I am aware that the zoning regulations require that the above property be posted for a period of thirty (30) days prior to the Zoning Commissioner taking any action, that said posting (sign) shall include information relative to the number of children, hours of operation, and number of employees, and that I am responsible for, and hereby agree, to pay expenses for all posting, advertising, and filing fees.

Kimberly LaValley
Applicant's Signature

CERTIFICATE OF POSTING

RE: Case No.: BUILDING PERMIT

Petitioner/Developer: KIMBERLY

LAVALLEY

Date of Hearing/Closing: 7-30-05

Baltimore County Department of
Permits and Development Management
County Office Building, Room 111
111 West Chesapeake Avenue
Towson, Maryland 21204

ATTN: Kristen Matthews {(410) 887-3394}

Ladies and Gentlemen:

This letter is to certify under the penalties of perjury that the necessary sign(s) required by law were posted conspicuously on the property located at: _____

2 GLENMORE AVE

The sign(s) were posted on 7-14-05
(Month, Day, Year)

Sincerely,

Robert Black 7-20-05
(Signature of Sign Poster) (Date)

SSG Robert Black

(Print Name)

1508 Leslie Road

(Address)

Dundalk, Maryland 21222

(City, State, Zip Code)

(410) 282-7940

(Telephone Number)

SCHEDULED DATES, CERTIFICATE OF FILING AND POSTING
FOR A CLASS A CHILD CARE CENTER USE PERMIT

The application for your proposed Class A Child Care Center has been reviewed and is accepted for filing by J. MEYER on 7.8.05.
DATE (A)

A sign indicating the proposed Child Care Center must be posted on the property for thirty (30) days before a decision can be rendered. Total cost, which includes application fee and posting, is \$75.00.

In the absence of a request for a public hearing during the 30-day posting period, a decision can be expected within approximately five weeks.

*SUGGESTED POSTING DATE 7.15.05
B (A + 7 DAYS OR NEXT FRIDAY)

DATE POSTED _____
C (CERTIFIED BELOW)

HEARING REQUESTED - YES _____ NO _____ - DATE _____

LAST DAY FOR HEARING REQUESTS _____
D (C + 30 DAYS)

APPROXIMATE DECISION DATE 8.17.05
E (A + 40 DAYS OR D + 5 WORK DAYS)

*Within 14 days of filing

CERTIFICATE OF POSTING

District _____

Location of Property: _____

Number of Signs: _____ Date of Posting: _____

Posted by: _____

Date 7-28-2005

To: Public Hearing Department
111 West Chesapeake Ave
Towson, Md.

From Joan A. Gelhardt
1 A Glenmore Ave
Balto, Md. 21206
410-668-8392

Check No. 4929
date 7-29-05
amt \$50.00

Case No.:

Formal Demand for Hearing for
2 Glenmore Ave
Balto, Md. 21206

.. concerning 12 children Day Care at
the above address.

Reason: Child safety, residential
area, four different people work
night shift

RECEIVED

JUL 28 2005

Per... *[Signature]*

**Department of Permits and
Development Management**

Development Processing
County Office Building
111 W. Chesapeake Avenue
Towson, Maryland 21204



Baltimore County

*James T. Smith, Jr., County Executive
Timothy M. Kotroco, Director*

August 11, 2005

Kimberly La Valley
5926 Clayton Avenue
Baltimore, Maryland 21206

Dear Mrs. LaValley:

RE: Teddy Day Care, 2 Glenmore Avenue, 14th Election District

This Office has received a formal demand for hearing regarding the above captioned matter. This will now require you to file of a Petition for Special Hearing and ultimately, a public hearing will be held before the Zoning Commissioner for Baltimore County for a determination as to whether the Day Care facility can locate at the Glenmore Avenue address. I have enclosed the information booklet and Petition forms for this filing. Should you have any questions regarding this matter, you may speak to one of our Zoning Planners at 410-887-3391 between the hours of 8:00 a.m. and 4:30 p.m., Monday through Friday. To receive a filing appointment for the review of your petition folder, you may call the number listed above and request same.

Sincerely,

A handwritten signature in black ink, appearing to read "Kristen Matthews".

KRISTEN MATTHEWS
Office Assistant
Zoning Review
410-887-3391

Visit the County's Website at www.baltimorecountyonline.info



ZONING NOTICE

BUILDING PERMIT APPLICATION

TO APPROVE A CLASS A GROUP CHILD CARE FOR
A MAXIMUM OF 12 CHILDREN IN A RESIDENCE. (Hours 7:00am - 5:30pm)
With 2 EMPLOYEES

PUBLIC HEARING ?

PURSUANT TO SECTION 210.4 BALTIMORE COUNTY REGULATIONS,
AN ELIGIBLE INDIVIDUAL OR GROUP MAY

REQUEST A PUBLIC HEARING CONCERNING
THE PROPOSED BUILDING PERMIT, PROVIDED THE REQUEST IS
RECEIVED IN THE ZONING REVIEW BUREAU BEFORE
5:00 P.M. ON JULY 30, 2005.

REQUEST FOR HEARING MUST REVEAL THE ADDRESS ON THIS SIGN.
ADDITIONAL INFORMATION IS AVAILABLE AT THE DEPARTMENT OF
PERMITS AND DEVELOPMENT MANAGEMENT, COUNTY OFFICE BUILDING,
511 WEST CHESAPEAKE AVE., TOWSON, MD 21286, (410) 887-3301.
DO NOT REMOVE THIS SIGN AND VIOLATION SUBJECT TO PENALTY OF LAW.
HANDICAPPED ACCESSIBLE

2 GLENDON AVE





BALTIMORE COUNTY, MARYLAND
OFFICE OF BUDGET & FINANCE
MISCELLANEOUS RECEIPT

No. 448201

DATE 7.8.05 ACCOUNT Pool- 006-6150

AMOUNT \$ 50.⁰⁰

RECEIVED FROM: Kimberly LaValley

FOR: USE Permit DATE CODE 12 children

DISTRIBUTION

WHITE - CASHIER

PINK - AGENCY

YELLOW - CUSTOMER

PAID RECEIPT

BUSINESS	ACTUAL	TIME	DRW	
7/08/2005	7/08/2005	09:23:25	5	
REG NS05	WALKIN	NSUN NEG		
>>RECEIPT # 385466			7/08/2005	GFJH
Dept 5 528 ZONING VERIFICATION				
CR NO. 448201				
Receipt Tot		\$50.00		
\$50.00 CR		\$0.00 CA		
Baltimore County, Maryland				

CASHIER'S VALIDATION

BALTIMORE COUNTY, MARYLAND
OFFICE OF BUDGET & FINANCE
MISCELLANEOUS RECEIPT

No. 8685

DATE 8/1/05

ACCOUNT 011-006-4120

AMOUNT \$ 50.00

RECEIVED FROM: Joan Bobhart
FOR: ~~Joan Bobhart~~ Fernal Demarel
1A Glenmore Ave

DISTRIBUTION
WHITE - CASHIER

PINK - AGENCY

YELLOW - CUSTOMER

8/05
EG #501
RECEIPT # 246220
5 528 ZONING VER
448685
Receipt Tot
\$50.00 OK
Baltimore County, Maryland
\$50.00 CA

CASHIER'S VALIDAT

No. 8685

AMOUNT \$ 50.00

YELLOW - CUSTOMER

PAID RECEIPT

BUSINESS ACTUAL TIME
8/02/2005 8/01/2005 11:00:59
EG #501 WALKIN JRIC JRC
RECEIPT # 246220 8/01/2005
448685
Receipt Tot
\$50.00 OK
Baltimore County, Maryland
\$50.00
1.00 CA

CASHIER'S VALIDAT

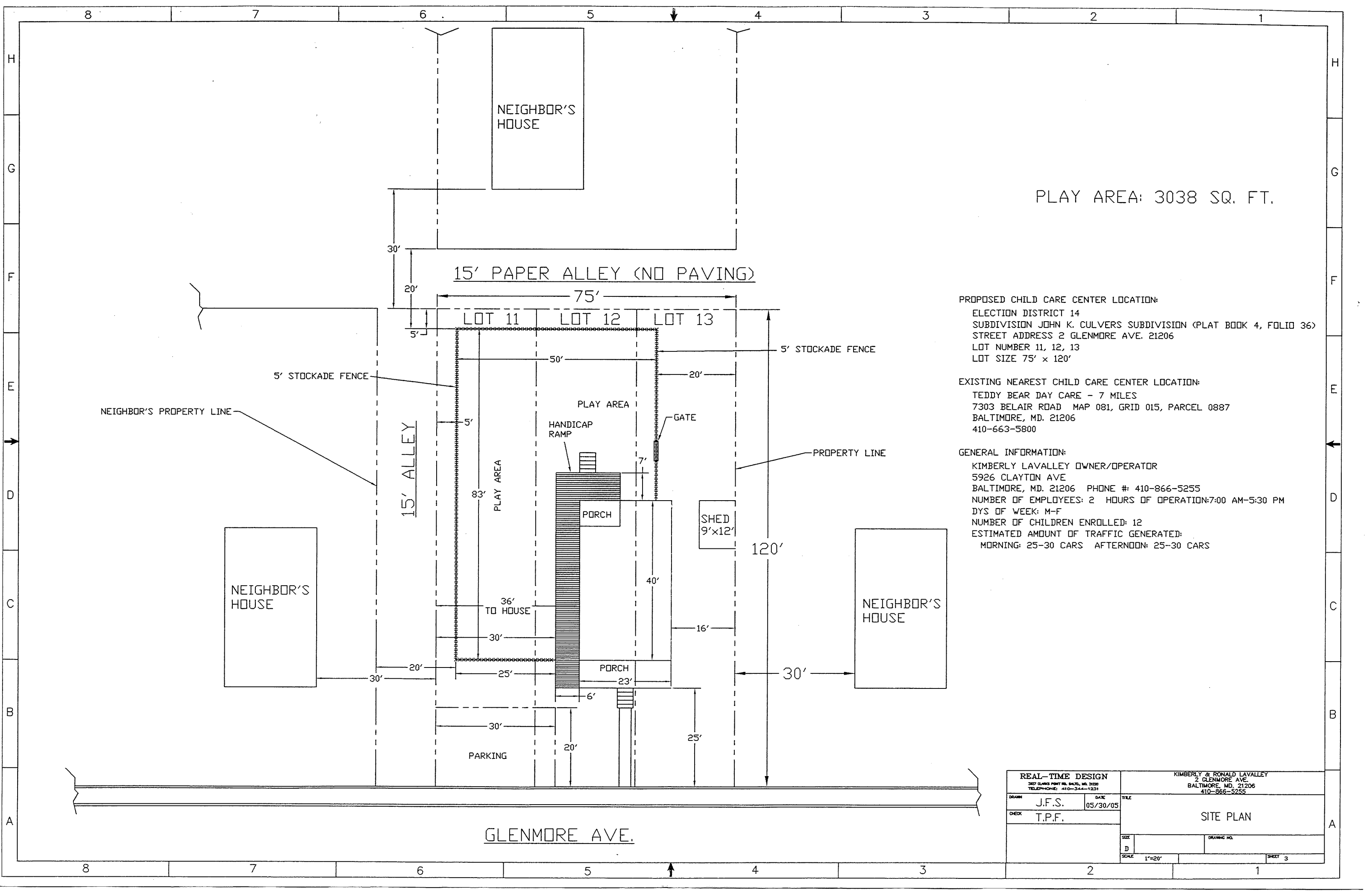

PLAY AREA: 3038 SQ. FT.

PROPOSED CHILD CARE CENTER LOCATION:

ELECTION DISTRICT 14
 SUBDIVISION JOHN K. CULVERS SUBDIVISION (PLAT BOOK 4, FOLIO 36)
 STREET ADDRESS 2 GLENMORE AVE. 21206
 LOT NUMBER 11, 12, 13
 LOT SIZE 75' x 120'

EXISTING NEAREST CHILD CARE CENTER LOCATION:

TEDDY BEAR DAY CARE - 7 MILES
 7303 BELAIR ROAD MAP 081, GRID 015, PARCEL 0887
 BALTIMORE, MD. 21206
 410-663-5800

GENERAL INFORMATION:

KIMBERLY LAVALLEY OWNER/OPERATOR
 5926 CLAYTON AVE
 BALTIMORE, MD. 21206 PHONE #: 410-866-5255
 NUMBER OF EMPLOYEES: 2 HOURS OF OPERATION: 7:00 AM-5:30 PM
 DYS OF WEEK: M-F
 NUMBER OF CHILDREN ENROLLED: 12
 ESTIMATED AMOUNT OF TRAFFIC GENERATED:
 MORNING: 25-30 CARS AFTERNOON: 25-30 CARS

REAL-TIME DESIGN <small>3827 GLENMOR POINT RD. BALTIMORE, MD. 21228 TELEPHONE: 410-344-1231</small>		KIMBERLY & RONALD LAVALLEY 2 GLENMORE AVE. BALTIMORE, MD. 21206 410-866-5255	
DRAWN J.F.S.	DATE 05/30/05	TITLE SITE PLAN	
CHECK T.P.F.		SIZE D	DRAWING NO.
		SCALE 1"=20'	SHEET 3