



**APPLICATION FOR FENCE PERMIT**  
BALTIMORE COUNTY, MARYLAND  
DEPARTMENT OF PERMITS, APPROVALS & INSPECTIONS  
111 WEST CHESAPEAKE AVENUE  
TOWSON, MD 21204

Permit No. \_\_\_\_\_  
Receipt No. \_\_\_\_\_  
Fee Paid \$ 25

Make checks payable to Baltimore County, Maryland --- PERMIT FEES ARE NON-REFUNDABLE

Tax Account # 09-18-722210 Zone 21204 DR 5 S

Type or print in ink:  
Work Site Address 403 Alabama Rd, Towson MD 21204 Election District 3  
Owner's Name Henry R. Ruark Phone No. 410 828 9101  
Mailing Address 403 Alabama Rd Towson, MD 21204  
Owner's Agent None Phone No. \_\_\_\_\_

COMPLETE SKETCH BELOW OR ATTACH A PLAN THAT CLEARLY SHOWS: Corner Lot: Yes  No   
Property line dimensions, easements, existing buildings, road names, and location of alleys. Historic District: Yes  No   
Proposed fence, total length 46', height 7', and type WOOD PRIVACY  
Property line setbacks: front 0, sides 0, and 0, and rear 0.  
Property use RESIDENTIAL. Rear/Side yard abuts adjoining front yard: Yes  No

**SITE PLAN**

**FENCE REGULATIONS**

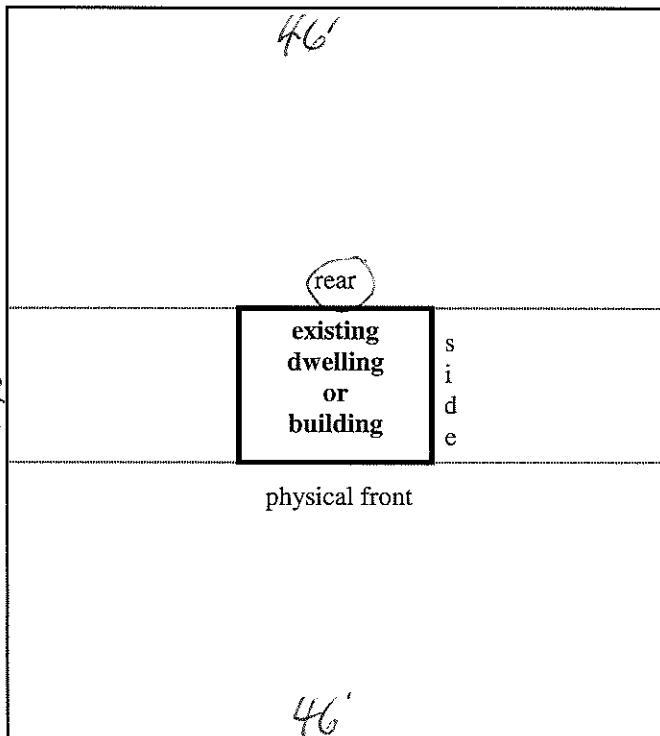

Road Name Alabama Rd.

Permit required for fences over 42 inches high (measured vertical to ground, even if fence is placed on top of wall). Fences erected within easement must be removed at owner's expense, if required.

**Building Code, Part 122:**

122.1 - Residential Fences -- Maximum height of 42 inches in front yard as determined by BCZR and 6 feet in side and rear yards at the property line. Maximum height of 10 feet in side and rear yards, provided set back 2 feet for vertical foot over 6 feet.

122.2 - Commercial Fences -- Maximum height of 12 feet. Building's Engineer may approve higher fence for dangerous, hazardous, or athletic field. Electric and barbed wire fences are only permitted for the retention of livestock and when not a safety hazard to the public. No pointed projections less than 4 feet high. Barbed wire retarding material may be on top of fence that is at least 6 feet, 9 inches high.

**Zoning Code (BCZR) (access easements cannot be fenced)**

102.5 - Corner Lot -- No fence or other obstruction to vision is permitted higher than 3 feet within 25 feet of a corner of two streets, 15 feet of a street and alley, and 10 feet of two alleys.

427 - Residential Fences in side or rear yard which adjoins residential front yard (setback and maximum height) - fence may not exceed 42" if situated within 10 feet of the adjoining front yard property line, with the exception of 48" pool fence and houses more than 200 feet apart.

**Special Fence Regulations:** Exist for Historic Properties, the Honeygo Overlay District, RC5, RC6, RC7 and RC8 Zones.

**Fence Waivers - Sec. 122.4:** All requests for a waiver of heights over 42" in front yard must be submitted to the Building Engineer. Waiver requests require posting and may require a public hearing if height is contested. Contested front yard waiver hearings are held before the Building Engineer. If a zoning variance and fence waiver are required, both hearings shall be before the Zoning Commissioner.

**County Code, Section 18-2-601, Obstruction of Drivers' View at Intersection.**

Corner Lots: The County Code does not allow a fence on a corner lot to obstruct the vision of drivers as they reach an intersection. If a sight problem is noted later, the property owner will be required to move the fence. To be safe, contact Traffic Engineering at 410-887-3554 for a free site inspection before you build the fence. An issued permit does **NOT** certify that the fence will be in compliance.

**OWNER/AGENT CERTIFICATION**

I have carefully read the above regulations and hereby certify that the proposed fence will be located on private property, and **NOT** within the 100-year floodplain, will not violate the codes, and that the information supplied is true, complete, and correct.

Henry R. Ruark \_\_\_\_\_ Henry R. Ruark  
Applicant Signature Date Print or Type Name

**PAI APPROVAL (FOR FENCE ONLY) Authority under Section 500.4, BCZR**

E. John B. ... \_\_\_\_\_ EJB \_\_\_\_\_ 5-9-19  
Approval Signature Print Initials Date

**APPLICANT - KEEP THIS COPY FOR YOUR PERMANENT RECORDS**



# Application for Administrative Waiver Of Building Code Fence Height Limitations

**Instructions:** Fill out the information below above the signature line, sign & date. Prepare and submit a **Site Plan** (see requirements on the back of this page) and **Certification of Posting** (provided by the sign poster) to the Zoning Review Office, Room 111, County Office Building, 111 W. Chesapeake Avenue, Towson, MD 21204. Note that if no public hearing is requested, the waive decision will be based on evidence presented along with County maintained information about the site.

Property Address 403 Alabama Rd, Towson MD 21204

Owner Henry R. Ruark

Owner Address 403 Alabama Rd., Towson, MD 21204

Corner Lot? Yes  No  Fence located in Front Side  Rear  Yard

Fence Height Allowed by Building Code 6' (0' setback)

Fence Height Requested 7' (Attach fence location drawing.) (0' setback)

Basis for Request:

Towson State College cut down all trees, bushes, vegetation on their property which screened my house from their Maintenance Bldg. Now all I see is solar panels and roof vents. Please see photo.

Also requesting waiver of 2 ft. offset

Applicant's Signature Henry R. Ruark Date: 4/17/19

(County Use Only)	<input checked="" type="radio"/> Waiver	Number <u>AA-2019-006-FW</u>
Date Property Posted	_____	
Input/comments/protests received within 15 days?	Yes/No	
Has Hearing been requested?	Yes/No	
(If Yes, attach record of Hearing)		
Final Disposition:		
_____		
_____		
_____		
_____		
Buildings Engineer	_____	Date _____



**Baltimore County Department of  
Permits, Approvals and Inspections**

Zoning Review Office

111 West Chesapeake Avenue, Room 111

Towson, MD 21204

410-887-3391

FAX 410-887-3048

**FORMAT FOR NOTICE OF FILING OF APPLICATION  
FOR FENCE HEIGHT WAIVER**

The sign to be posted must be obtained from any of the county's list of approved sign posters. The sign will be the standard 24" x 36" size used for zoning variances, and will contain the following language:

AA-2019-0006-FW

**NOTICE**

A request has been made for a waiver to construct a fence higher than allowed in accordance with PART 122.4 of the Baltimore County Building Code.

Fence location: REAR YARD

Height allowed: 6'

Height requested: 7' with 0' setback

Anyone living within 1,000 feet of this property may request a public hearing on this matter if such request is made within 15 days of the posting date set forth below or submit written comments for consideration to the address below.

Posting Date: APRIL 18, 2019

Address: 403 ALABAMA RD

Please call 410-887-3391 for more information or contact the:  
Zoning Review Office  
Department of Permits, Approvals and Inspections  
111 West Chesapeake Avenue, Rm. 111  
Towson, MD 21204

CLOSING DATE: MAY 3, 2019



ALABAMA ROAD

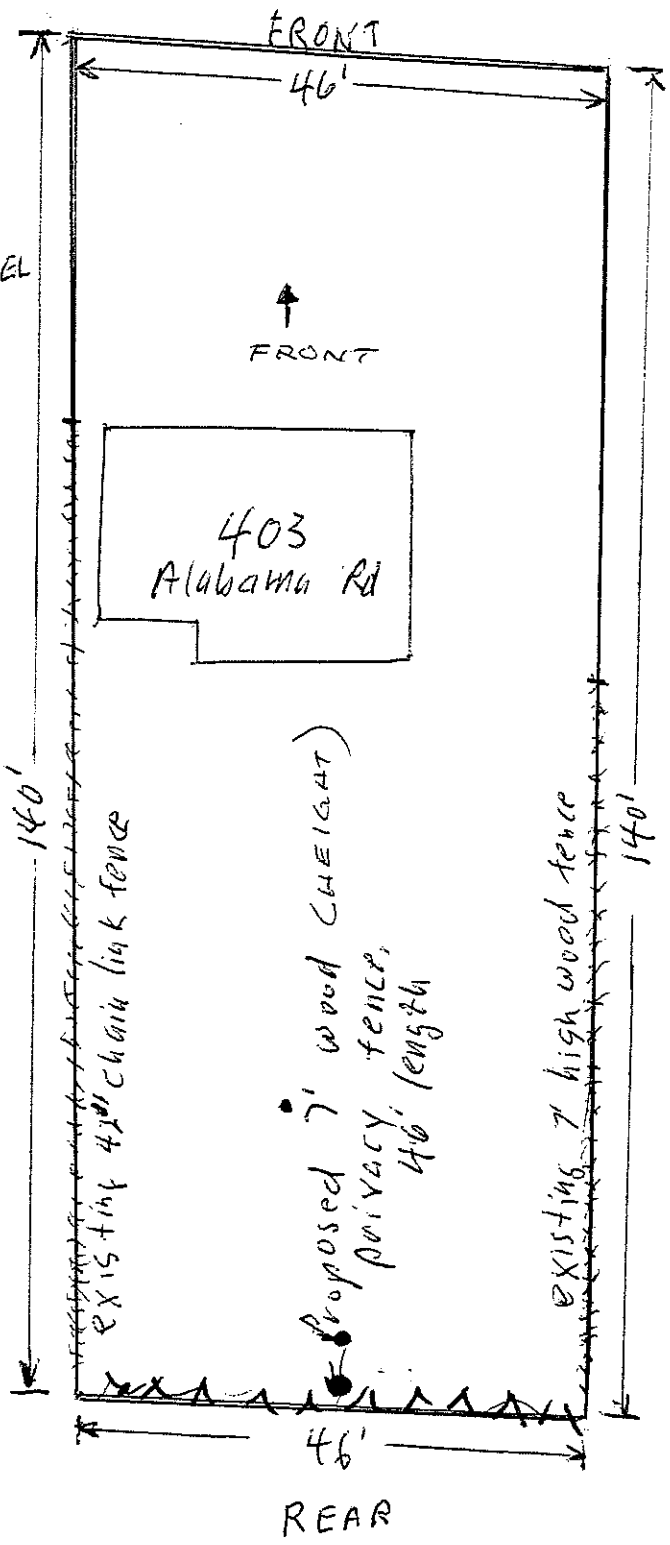

OWNER  
JAKE + MICHAEL  
Verdis

401  
Alabama  
Rd

OWNER  
Bob + Sue Corona

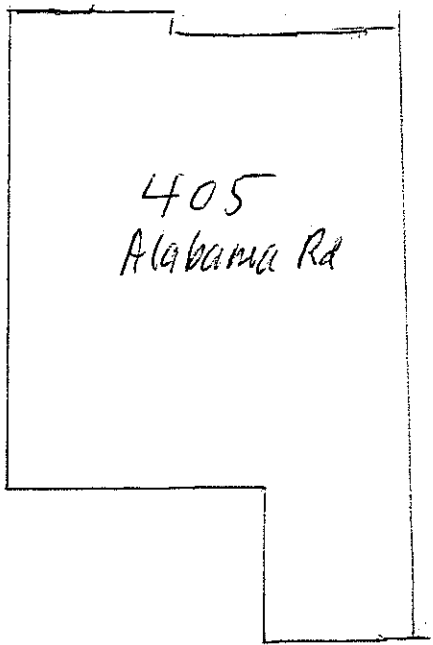

Towson State College

1 inch = 20 ft

CERTIFICATE OF POSTING

Date: 4-18-19

RE: Case Number: AA-2019-0006-FW

Petitioner/Developer: Henry Ruark

Date of Hearing/Closing: NA

This is to certify under the penalties of perjury that the necessary sign(s) required by law were posted conspicuously on the property located at 403 Alabama Rd

The signs(s) were posted on 4-18-19  
(Month, Day, Year)

J. Lawrence Pilson  
(Signature of Sign Poster)

J. LAWRENCE PILSON  
(Printed Name of Sign Poster)

ATTACH PHOTOGRAPH

1015 Old Barn Road  
(Street Address of Sign Poster)

Parkton, MD 21120  
(City, State, Zip Code of Sign Poster)

410-343-1443  
(Telephone Number of Sign Poster)

# NOTICE

AA-2019-0006-FW

In accordance with Section 3111.4 of the Baltimore County Code, a request has been made for a waiver to construct a fence higher than allowed.

SEE ALSO PART 122.4  
OF THE BALTO. & BLDG  
CODE

## Request information:

Fence location: REAR YARD

Height allowed: 6'

Height requested: 7' WITH 0' SETBACK

Anyone living within 1,000 feet of this property may request a public hearing on this matter if such request is made within 15 days of the posting date set forth below or submit written comments for consideration to the address below.

Posting Date: 4-18-19

Address: 403 ALABAMA RD

Please contact

for information 410-887-3391

Department of Permits APPROVALS & INSPECTIONS

111 West Chesapeake Avenue, Rm. 111

Towson, Maryland 21204



ALABAMA ROAD

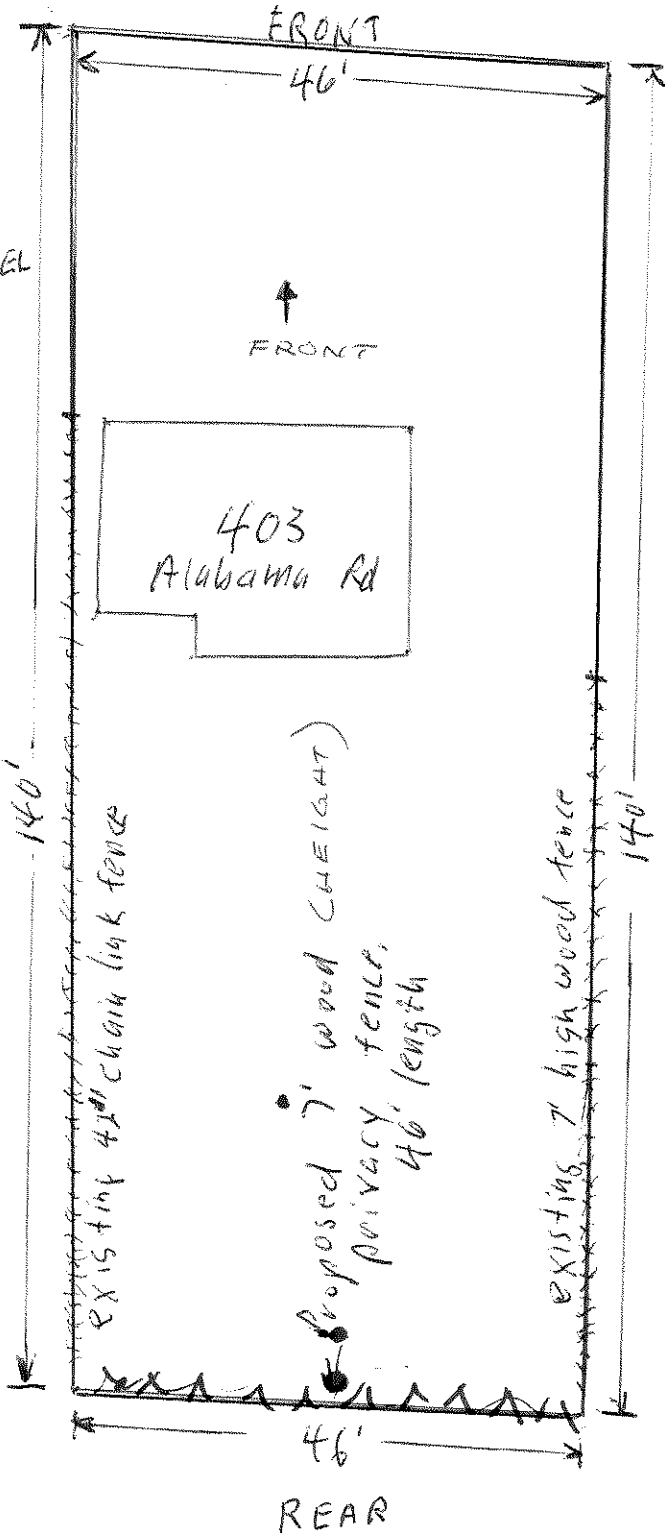

OWNER  
JAKE + MICHAEL  
Verdis

401  
Alabama  
Rd

403  
Alabama Rd

OWNER  
Bob + Sue Corona

405  
Alabama Rd

140'

EXISTING 4" chain link fence

Proposed 7' wood CHEIGAT  
privacy fence,  
46' length

EXISTING 7' high wood fence

170'

46'

REAR

Towson State College

1 inch = 20 ft