



\$200⁰⁰⁷

BALTIMORE COUNTY DEPARTMENT OF PERMITS, APPROVALS & INSPECTIONS 111 WEST CHESAPEAKE AVENUE TOWSON, MD 21204 410-887-3391

UP-2019-0017-SI

B _____ A 182566

The applicant is authorized to affirm that there are no current violations at this site pursuant to Section 112.7 BCC Initials [initials]

SIGN USE PERMIT

Permit Fees are Non-Refundable; Make Check Payable to "Baltimore County, Maryland"

PROPERTY ADDRESS 8905 Belair Rd. Nottingham, MD ZIP CODE 21236
BUSINESS NAME W ARC PH Centre Owner VIII, LLC ZONING B/M
OWNER'S NAME Zack Bosse (Rep.) PHONE NO. (703) 760-9500 HISTORIC DISTRICT [] Yes [x] No
MAILING ADDRESS 8150 Leesbury Pike ste. 1100, Vienna, VA 22182
APPLICANT/OWNER'S AGENT Zack Bosse (Rep.) PHONE NO. (703) 760-9500
SIGN COMPANY NAME Forman Signs PHONE NO. (215) 827-6500
TYPE OF SIGN: [] Window Sign TAX ACCOUNT NO. 1581-3705576

[] Temporary- Including Real Estate/Construction/Event Temporary Signs in the Last Year: [] Yes [x] No
[] Permanent [] Changeable Copy [] Wall [] Face Change Only [] Non-Illuminated 1700006877
[x] Freestanding [x] Pylon [] Monument [x] Illuminated (separate electrical permit required)

Size: 12.5 feet x 10 feet = 125 square feet Height: 24 feet (freestanding signs)

Property Line/Street Right-of-Way Setbacks: front 2.8', sides 50' (W) and 49.3' (N) and rear 1425.8'

NOTE: A construction plan, drawn to scale and clearly showing that all requirements have been met, must be attached; a site plan also must be attached for freestanding signs.

Table of Sign Regulations: 450.4.Attachment 1, 1.- An Electronic Changeable Copy Sign may only have a maximum Frequency of one instantaneous message change per 15 second cycle.

450.6.B.3 Changeable copy signs must operate at a constant intensity and not give the appearance of movement by flashing, blinking, strobing, scrolling, oscillating, or alternating lights.

PROHIBITIONS: including roof signs (Sections 450.5.B.7 and 450.6.A, Baltimore County Zoning Regulations):

- 1. Signs cannot impair motorist's clear view of traffic or government signs. All signs are subject to Section 102.5, BCZR.
2. Signs cannot imitate or resemble government signs, except for private traffic control and notice signs.
3. Signs cannot be placed in or project into or above street right of way or governmental property.
4. Sign or framework cannot obstruct window or opening for light and air or access to building, fire hydrant, or stand pipe.
5. Vehicle cannot be parked for the purpose of displaying an attached sign.
6. Except for flags exempted, flags, pennants, ribbons, streamers, tethered balloons, laser projections, and similar objects are prohibited.
7. Portable signs are prohibited, except for A-frame and sandwich board signs issued a use permit in B.M. - C.T. zones.
8. There can be no display or simulation of moving parts or message, except for an outdoor advertising sign with tri-vision, a changeable copy sign, or a thermometer, barometer, weather vane, barber pole, or clock.
9. No sign may emit sound

ZONING CASE # 2018-350

Work Description (including number of signs, special conditions, materials, locations and size):

1 sign of this type to be installed. Materials include steel structure, aluminum sign cabinet, aluminum cap and trim, internal LED lights, and stone veneer at base of columns. Located at entrance to 8905 Belair Rd. Sign cabinet size to be 12.5' H x 10' W. Total height to be 24' high. CORNER LOT []

OWNER/AGENT CERTIFICATION

I solemnly affirm under the penalties of perjury and upon personal knowledge that the contents of the above are true and further agree to locate the proposed sign such that it will not violate Baltimore County laws and regulations.

Signature [Signature] Date 2/1/19 Print/Type Name Zachary P. Bosse

[x] Require Planning Signature Brett M. Williamson Date 4/22/19

Copies: White-Office; Yellow- Applicant (keep this Copy for your permanent records)

REV 10/14

Authority under Section 500.4, BCZR PAI Approval (SIGN ONLY)
Signature [Signature] Initials gh Date 4/22/19



Permits, Approvals & Inspections

111 W. Chesapeake Avenue
Towson, MD 21204

Report Generated On:
4/22/2019

Permit Processing Commercial Permit & Development Report

Page 1 of 1

Property Information

Tax Account Number: **1700006877**

Election District: **11**

Owner Name(s): W ARC PH CENTRE OWNER VIII LLC and C/O WALTON STREET CAPITAL LLC

PDM #: 11-0859

Address: SUITE 1900 900 NORTH MICHIGAN AVE
CHICAGO, IL 60611

Zoning District(s):

Premise Address: 8903 BELAIR RD

Elevation Range: 194ft - 224ft

Affected Overlays	Instructions: Begin review process with Zoning Review, Room 111	New Com Bldg	Interior Alts.	Add / Ext. Alts.	Piers/Pilings	Grading/SW	Tanks	Ret.Walls/Bulk	Razing	Chg. of Occup.	Tower Antenna	Signs	Elect. & Plumb	Agency Acknowledgment Initial & Date
Contact Agency	Potential Overlay Issues													
	Growth Tier 1: Served by public sewer and inside URDL													
Planning Jefferson Building Room 101 Phone: 410-887-3211	Commercial Design Review Areas - Perry Hall	X	X									X		<i>Final BMW</i> <i>4/22/19</i>
	Commercial Revitalization Districts - Perry Hall	X	X									X		
DEPS-Sed. Control Jefferson Building 4th Floor Phone: 410-887-3226	Note: All Razing Permits must be sent to Sediment Control for review.													
PAI-Public Services County Office Building Room 119 Phone: 410-887-3751	Note: All permits for Grading, New Buildings & Building Additions must be sent to Public Services.													
Zoning Review County Office Building Room 111 Phone: 410-887-3391	Zoning Cases: 2019-0253-SPHA; 2018-0350-SPHA; 1968-0229-A; 1973-0103-A; R-1953-2641; R-1969-0139	X	X	X	X	X				X	X	X		

Notice: This report is not inclusive as additional issues may arise which would affect the ability to obtain a building permit. This Report is solely for Departmental use and nothing herein creates any right which would accrue to the applicant.
Form171C

SIGN LOCATIONS

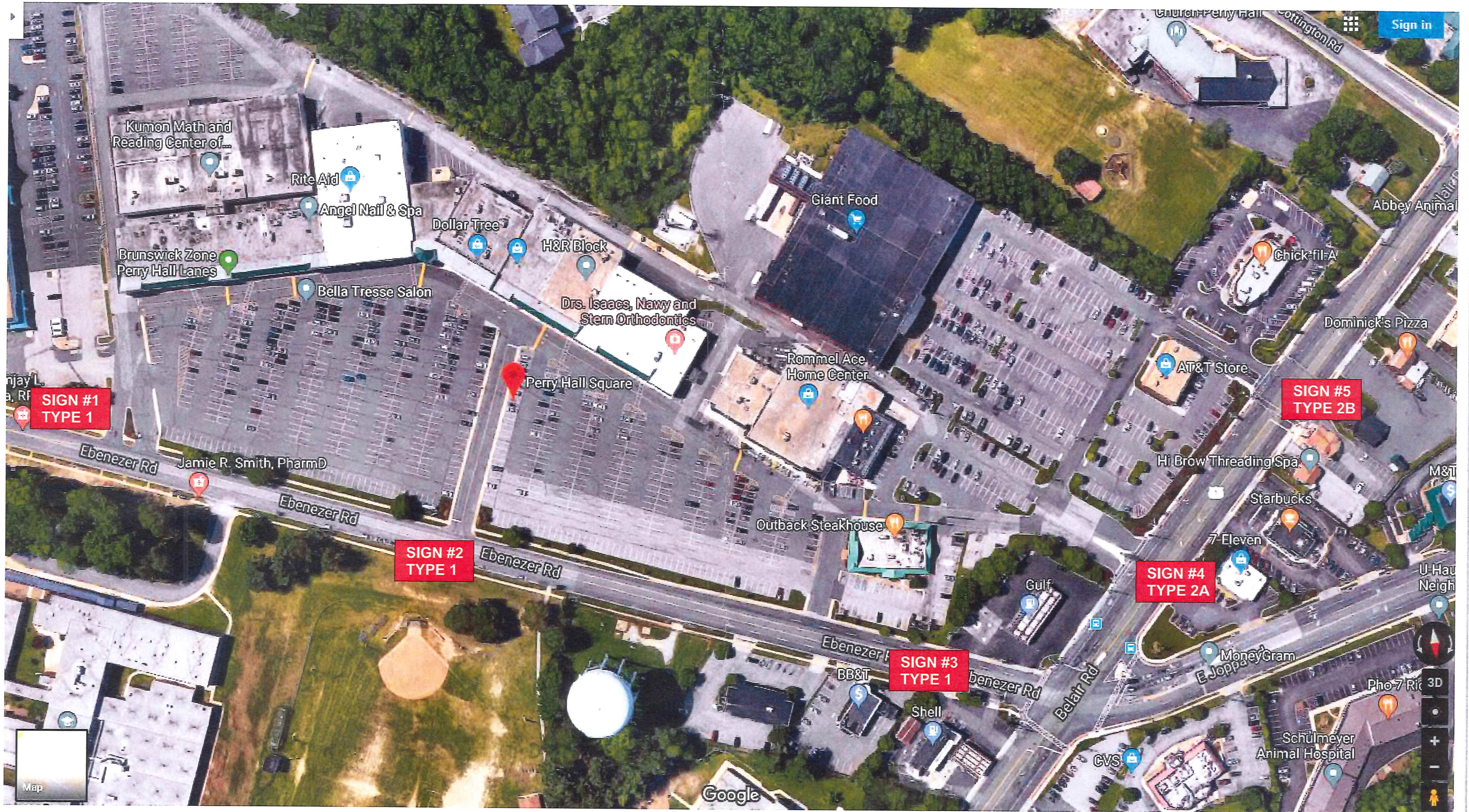

PERRY HALL SQUARE

LOCATION:
Nottingham, MD

SCALE: as noted PG: 1 of 10

FILE: Perry_Hall_Square_sign-program_4-17-19

DRAWN BY
ebf

DATE:	9/4/18	3/29/19
	10/22/18	4/17/19
	10/29/18	
	11/9/18	
	3/28/19	

215-827-6500 • 215-827-6501 fax
erikh@formansign.com
©2007 forman sign company. All rights reserved. No part of this document or the related files may be reproduced or transmitted in any form, by any means (electronic, copying, or otherwise) without the prior written permission of forman sign company.

formansigns
10447 Drummond Rd, Philadelphia, PA 19154

LOCATION;
SIGN # 4: TYPE-2A



PERRY HALL SQUARE

LOCATION:
Nottingham, MD

SCALE: as noted

PG: 5 of 10

DATE: 9/4/18 | 3/29/19
10/22/18 | 4/17/19
10/29/18

FILE: Perry_Hall_Square_sign-program_4-17-19

DRAWN BY
ebf

11/9/18
3/26/19

215-827-6500 • 215-827-6501 fax
erikh@formansign.com
©2007 forman sign company. All rights reserved. No part of this document or the related files may be reproduced or transmitted in any form, by any means (electronic, copying, or otherwise) without the prior written permission of forman sign company.



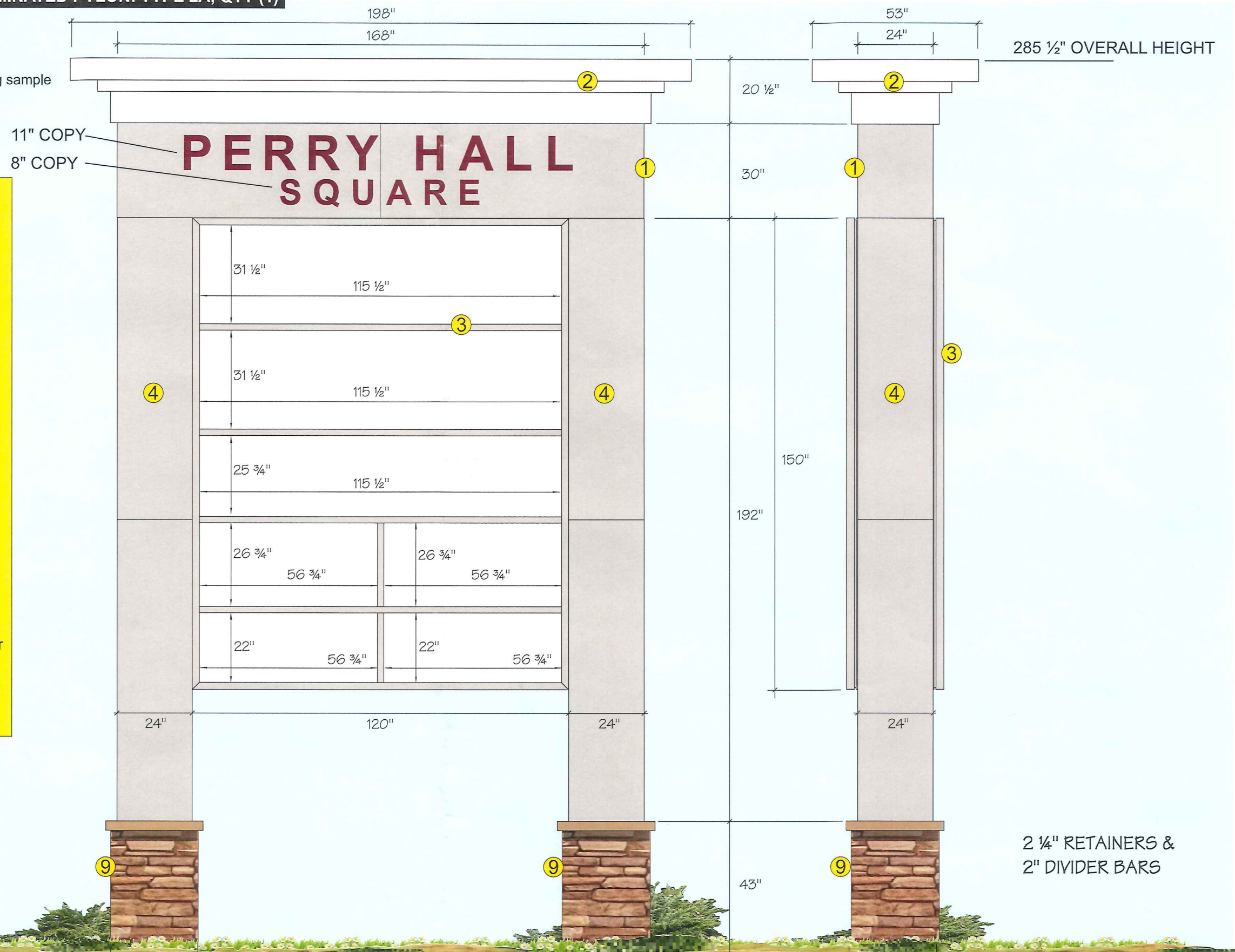

SIGN #4 - INTERNALLY-ILLUMINATED PYLON: TYPE 2A, QTY (1)

- White caps - Sw006 - Extra White - 257-C1
- Stone - El Dorado - see page #2 spec
- "Perry Hall Square" lettering - Burgundy to match awning sample



- 1) Top illuminated section:
 - fabricated alum. cabinet; .125" alum. exterior w/ internal alum. angle frame
 - 3/4" thick acrylic push thru copy w/ red vinyl overlay
- 2) Fabricated alum top - - fabricated alum. cabinet; .125" alum. exterior w/ internal alum. angle frame
- 3) Multi-tenant cabinet,
 - Fabricated alum. cabinet, .125" alum. exterior w/ internal alum. angle frame
 - 2 1/4" Extruded face frame w/ extruded alum. retainers & 2" divider bars
 - Removable panels of 3/16" white acrylic decorated w/ vinyl
 - 3" steel sq. tube supports welded to angle-iron clips welded to beams
- 4) Pole covers; fabricated alum. w/ .125" alum. exterior & internal alum. angle frame
- 5) LEDs - white
- 6) Power supply - 120V primary service w/ Class II secondary wiring to LEDs
- 7) Steel beam poles; 8" x 8" "I" beams - existing
- 8) Angle-iron cradles welded to beams & bolted to alum. frame w/ 1/2" hex cap screws - all dissimilar metal interfaces to be painted
- 9) Masonry base, stone veneer - see page #2 spec - on CMU core w/ pre-cast cap stone

	SW 7649 (239 C5)
	SW 006 (257 C1)
	"Burgundy" to match awning material (see photo)

PERRY HALL SQUARE

LOCATION: Nottingham, MD

SCALE: 3/8" = 1' - 0"
 PG: 6 of 10
 DATE: 9/4/18 | 3/29/19
 10/22/18 | 4/17/19
 11/9/18
 3/28/19
 FILE: Perry_Hall_Square_sign-program_4-17-19
 DRAWN BY: ebf

215-827-6500 • 215-827-6501 fax
 erikh@formansign.com
 ©2007 Forman sign company. All rights reserved. No part of this document or the related files may be reproduced or transmitted in any form, by any means (electronic, copying, or otherwise) without the prior written permission of Forman sign company.





SIGN #4 - INTERNALLY-ILLUMINATED PYLON: TYPE 2A, QTY (1)

NOTE: EXISTING POWER SERVICE

- 1) Top illuminated section:
 - fabricated alum. cabinet; .125" alum. exterior w/ internal alum. angle frame
 - 3/4" thick acrylic push thru copy w/ red vinyl overlay
- 2) Fabricated alum top - - fabricated alum. cabinet; .125" alum. exterior w/ internal alum. angle frame
- 3) Multi-tenant cabinet;
 - Fabricated alum. cabinet; .125" alum. exterior w/ internal alum. angle frame
 - Extruded face frame w/ extruded alum. retainers & divider bars
 - Removable panels of 3/16" white acrylic decorated w/ vinyl
 - 3" steel sq. tube supports welded to angle-iron clips welded to beams
- 4) Pole covers; fabricated alum. w/ .125" alum. exterior & internal alum. angle frame
- 5) LEDs - white
- 6) Power supply - 120V primary service w/ Class II secondary wiring to LEDs
- 7) Steel beam poles; 8" x 8" "I" beams - existing
- 8) Angle-iron cradles welded to beams & bolted to alum. frame w/ 1/2" hex cap screws - all dissimilar metal interfaces to be painted
- 9) Masonry base, stone veneer - see page #2 spec - on CMU core w/ pre-cast cap stone

NOTE: FOOTING FOR BASE TO BE DETERMINED DEPENDING ON EXISTING FOOTINGS FOR POLES

	SW 7649 (239 C5)
	SW 006 (257 C1)
	"Burgundy" to match awning material (see photo)

20amp rated weatherproof Cut-off switch mounted to inside of sign *

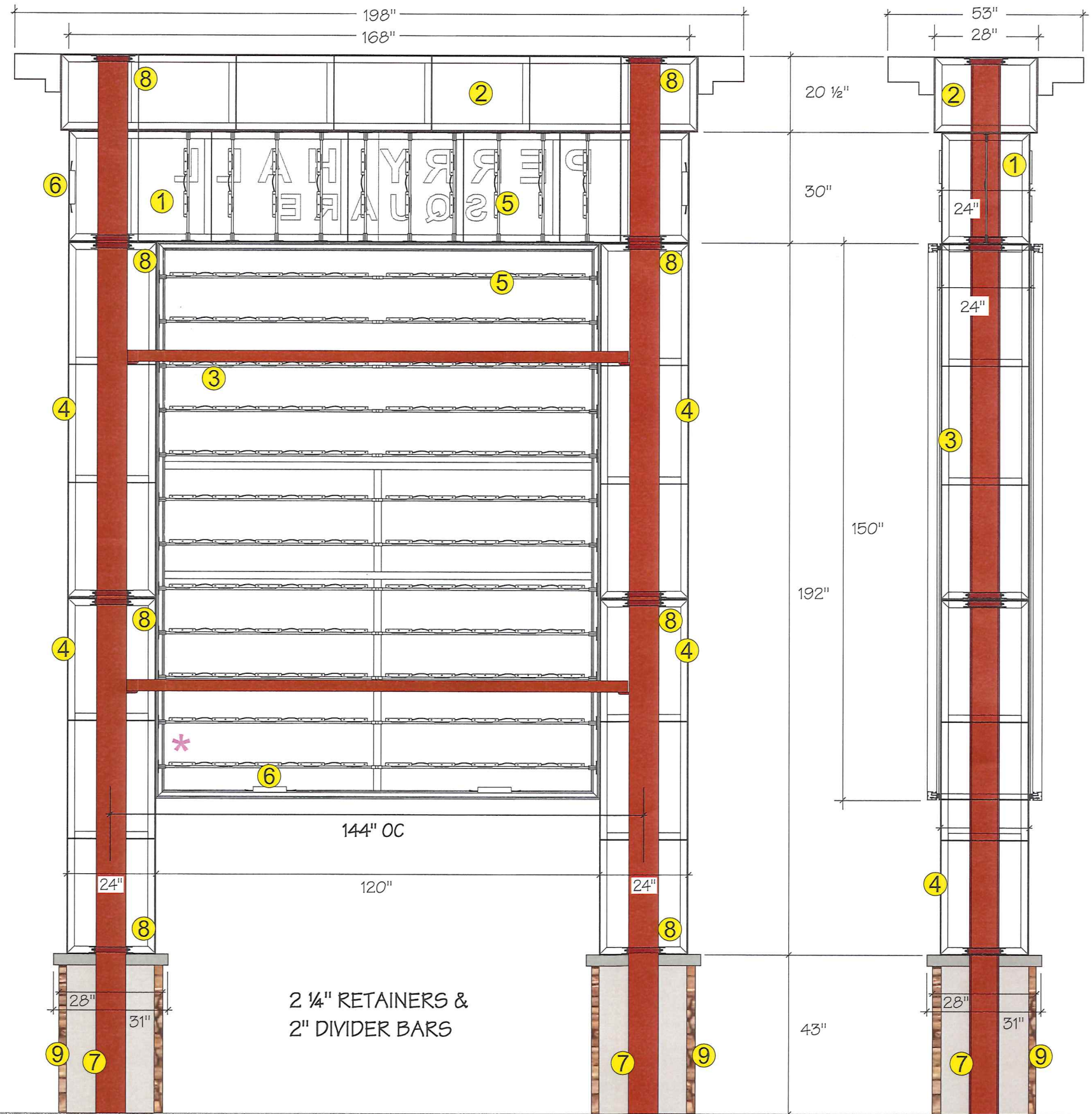
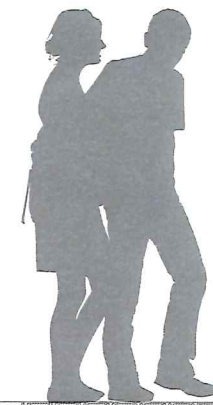

PERRY HALL SQUARE

LOCATION:
Nottingham, MD

SCALE: 3/8" = 1' - 0"

PG: 7 of 10

DATE: 9/4/18 3/29/19
10/22/18 4/17/19
10/29/18
11/9/18
3/28/19

FILE: Perry_Hall_Square_sign-program_4-17-19

DRAWN BY
ebf

215-827-6500 • 215-827-6501 fax
erikh@formansign.com
©2007 Forman sign company. All rights reserved. No part of this document or the related files may be reproduced or transmitted in any form, by any means (electronic, copying, or otherwise) without the prior written permission of Forman sign company.

formansigns
10447 Drummond Rd, Philadelphia, PA 19154